

# 2018/19



PERFORMANCE EQUIPMENT FOR HARSH ENVIRONMENTS

DINGHY YACHT MOTOR DECK INDUSTRIAL



**CYBER  
ESSENTIALS**



3 hole verniers	18	Halyard key shackles B	56	<b>NEW</b> Shock Mitigation & Seat Suspension Units	6
25mm stainless sheave blocks	41	Hanks	34	Shroud adjusters	18/27
Adjustable extensions	13	Harness safety catches	65	Shuttle blocks	44
Adventurer Series grills	77	Hasp and staples	64	Sister hooks	20
Alloy sheave blocks	42	Hatch covers	18	<b>NEW</b> Skydex Quick-Fit Decking	7
Ball Stops	22	Hatch lock	65	Sliders – nylon	35
Big head design	49	Headboards	34	Snap shackles	59
Belaying hook/rope tidy	47	Headboard liner	34	Spar clips and eyes	53
Block accessories adaptors & swivels	45	<b>NEW</b> High Load Block	5	Special clew rings	31
Blocks – 19/28mm carbon fibre cheeked ball race blocks	38	Highfield lever	27	<b>NEW</b> Speed Six	4
Blocks – 25mm	37	Hinges	64	Spinnaker equipment	48
Blocks – 38mm	43	Hooks	53	Spinnaker guy hooks	19
Blocks – 19mm carbon fibre sheaves	43	<b>NEW</b> Infinity Furler	5	Spinnaker pole fittings	19
Blocks – 16mm mini blocks	44	Inglefield hooks	36	Split rings	50
Bow shackles	57	Inner forestay lever	27	Stanchion mounting eyes	52
Brass sheave blocks	42	Key pin shackles	56	Strip shackles	56
Buckles	61/62/63	Kicking strap sets	21	Supersuck bailer	17
Budget chain hook	50	Knives & tool kits	83	Swage terminals	29
Carbine hooks	53/54	Lacing button	36	Swivel anchor connector	50
Carbon fibre roller race blocks	40	Lavac Popular toilet	69/70	Swivel shackle	57
Clamp plates	61	Lavac Popular & Zenith toilet spare parts	71	Tack bar furler	17
Classic Gourmet Series	76	Lavac sanitation pumps	72	Tangs	51
Cleats fairleads & rollers	46	Lavac toilets	69/70	Tape	84/85/86
Clevis pins	50	Link shackles	59	Taylor's heaters – paraffin	75
Clew blocks	31	Marine kettle grills – charcoal	77/78	Taylor's heaters – diesel	75
Cockpit safety eye	65	Marine kettle grills – gas	78	Taylor's paraffin cookers	73/74
Connoisseur Series grills	77	Marine kettle 3 combination stove & gas grill	78	Thimbles	28
<b>NEW</b> Contact Tiller Extension Joints	4	Mounts – rectangular grills & tables	79	Thimble button	28
Cooker spares	74	Mounts – marine kettle grills	79	Tiller extensions	13/14
Cooking accessories	81	Naval bronze boat snaps	56	Tiller extension accessories	14
<b>NEW</b> Clew Block	5	Nicopress ferrules	25	Tiller extension end sets	15
Decks eyes	51	Nicopress hand tool – small	24	Tiller extension joint kits	15
Drop nose pins	49	Nicopress tools	25	Tiller lock	9
D-Rings	32/33	<b>NEW</b> Pad-I	5	Toggle buttons	36
D-Shackles	55/57/58	Pelican hook	29	Toilet spare parts	67
Eye bolts	59	Pintles & gudgeons	10/11	Tournament series cleaning stations	82
Eye plates	52	Reefing blocks	31	Trapeze handles	16
Eye plates – dinghy	21	Rings	32	Trapeze hooks	22
Fastleads	39	Riveters and rivets	26	Trapeze rings	16
Felco cutters	26	Rope stops	22	Trapeze set – complete	16
Forged asymmetric carbine hooks	54	Rudder Accessories	12	Triangles	33
Forged carbine hooks	53	Rudder stocks	8	Triangular plate	30
Fork and eye toggles	30	'S' hooks	53	Turnbuckles	27/29
Fork and fork toggles	30	Saddle washers	47	Twisted shackles	57/58
Furlers	5/17	Sail feeders	20	U-bolts	60/61
Gourmet series cookware	80	Seacocks	68	Universal adapter	70
Gourmet Series grills – infrared	76	Life line link	65	Washers	50
Grill covers	78	Sew on hooks and eyes	36	Wire	24
Gunwhale eyes	52	Shackles – nylon	35	Wire rope grips	29
		Shackle key	59		

# SPEED SIX

- REDUCE FRICTION
- INCREASE PERFORMANCE
- CARBON SHIELD
- FOOD SAFE
- NONCARCINOGENIC
- BIODEGRADABLE

**Part number 60.60**

SPEEDSIX is a highly versatile dry lubricant for all components including the hull surface. Formulated to withstand harsh salt water environments, SPEEDSIX will extend the life of your boat whilst delivering extended performance to all blocks, rollers, sheaves, mast track, furlers and jib cars. SPEEDSIX will lubricate and protect all carbon fibre, wood, nylon, stainless steel, brass, aluminium, leather and composite materials.

**The Green Bit**

SPEEDSIX is powered by ProLan - 100% environmentally friendly, biodegradable, non-carcinogenic and most importantly certified safe to be used within the food chain. Therefore once applied and dried safe for your boat, safe for you and safe for the environment. Lanolin is a natural product (wool wax) from sheep it is the evolution by nature which has given this incredible capability of providing an environmental barrier which is not only weatherproof but extremely low in friction.



# CONTACT TILLER EXTENSION JOINTS

Contact tiller extensions joints have been designed by Derek Clark, a former Americas Cup sailor, designer and current coach to the British Sailing Team to specifically cater for longer tiller extensions. The specially made joint in the contact is 50% larger in diameter making it far stronger for the increased helm loads and length of extension. A simple C shaped clip has been designed so that you can easily remove the tiller extension after racing. Contact has been designed to be used with either 22mm or 25mm.

**Contact 1**

Designed for a single tiller extension, Contact 1 suits fast skiffs with longer extensions such as the Musto Skiff, RS700, RS600 & Contender. The joint faces towards the front of the boat rather than directly upwards. This means that the tiller extension constantly wants to be by the side of the helmsman due to the stiffness of the joint.

**Contact 2**

Contact 2 suits boats such as the 49er, RS800, B14 & Cherub. Contact 2 has the same simple C clip that the contact 1 has which allows for easy removal of the tiller extension. Due to being on top of the tiller in 1 single unit, it allows the helm to be in contact with the extension throughout manoeuvres, rather than dropping and re grabbing as you do with the standard joints. The Stiffness of the joint helps keep the tiller by the side of the helm rather than catching in the waves and being swept out the back of the boat.



P/No	DESCRIPTION	Dim A
23.66s	Contact 1	22mm
23.68s	Contact 1	25mm
23.66	Contact 2	22mm
23.68	Contact 2	25mm

## INFINITY FURLER



### Part Number 25.70

Using the latest 3D printing technology we have designed, tested, improved and produced a new code zero continuous line furler for small dinghies, catamarans and inflatable boats. From the outset our aim was to improve on the units that are currently on the market. We believe we have achieved this by incorporating our current 316 Stainless Steel central column from our drum furler, and designing a completely new outer casing and drum. The top of the drum has large tear drop holes to help grip the rope for minimal slip, and to reduce the overall weight. By using our existing central column and bearings it means that we have a unit that has been tried and tested for the last 25 years, and has a significantly higher working and breaking loads (1000Kg) compared to other continuous line furler's of comparable size on the market today as they are mainly all plastic. The Infinity furler is extremely light at only 135 grams showing that there has been no compensation for weight/strength.

## CLEW BLOCK



### Part number 04.90NEW

The new 04.90 has had a small facelift from the previous 04.90 that has more than proven itself for over 30 years. The 3 stainless rivets have been removed and replaced with 1 large central hollow rivet. This makes the product more aesthetically pleasing and slightly lighter, however it still has the same working and breaking loads meaning that compared to other manufacturers clew blocks ours still have the highest load capabilities. We are also able to anodise the block in a large range of different colours and manufacture the plastic components including the sheave, slot protectors and the central bush in different colours to fit in with the sail maker's company marketing schemes.

## ULTRA HIGH LOAD BLOCK



### Part Number 01.66

On boats such as an International Moth the vang system can produce loads in excess of 1000kg. We have produced a light weight Ultra High Load block that has a breaking load well in excess of 2000Kg. The block incorporates 4mm SK99 Dyneema which takes a large proportion of the loading due to the innovative design. The Ultra Block uses a Toughmet spinodal plain bronze bearing which has an extremely wide working temperature range as well as having very low friction.

As well as having a breaking load over 2000Kg, probably the most astounding feature of our Ultra Block is that it only weights 39 grams. Available in a range of colours – Black, Silver, Blue, Purple, Gold.

## PAD-I



### Part number 25.20

PAD-I has been designed to allow you to fix low loading parts to your boat/deck without having to drill attachment holes. PAD-I has been manufactured using carbon filled nylon so it is extremely strong. It comes complete with a length of 1.5mm SK99 Dyneema which means that the whole unit only weight 5.5 Grams.

The PAD-I is stuck to the hull/deck using Sikaflex. PAD-I is able to take 80kg's of force before lifting from the deck. This makes putting simple take up systems into the boat extremely easy.

### Dimensions

Diameter 32mm  
Height 8mm  
Weight 5.5grams

# SHOCK MITIGATION & SEAT SUSPENSION UNITS

## Shock Mitigation by all Means

Born out of a personal wish to have a safer, more comfortable ride aboard a motor boat, our shock mitigation units significantly reduce the shock on the body from harsh wave impacts.

We have been manufacturing solid dependable marine and aerospace equipment for more than 50 years. This experience of developing, testing and refining products to survive in harsh marine environments has been key to our success. Our units are now being used all over the world in personal and light commercial craft.

To complement our own equipment we have teamed up with SKYDEX Inc, world leaders in advanced impact mitigation and cushioning solutions to provide shock mitigation seating with built in SKYDEX seat inserts, and a shock mitigating decking to give a complete whole body vibration (WBV) solution for water craft whether standing or sitting.

Our system has been designed to be easily retro-fittable with little to no alterations needed on the boat. This is by far the most cost effective way of meeting the current WBV legislations.

For more information regarding our RIB and Pedestal based systems please call 01489 885 401 or email: [sales@sea-sure.co.uk](mailto:sales@sea-sure.co.uk)

We have a vast amount of performance data, please contact us directly with your application and we will be more than happy to help.



## Benefits

- Proven Performance
- Retro-fit Design
- Increased comfort
- Low cost

## Designed for

- Leisure use
- Coach Boats
- Commercial/Coastal/SAR use
- Coastguards & Pilots

## Extensively Tested

- In-house drop test facility
- In-house static testing
- On water testing



# SKYDEX QUICK-FIT™ DECKING



Superior  
Shock Mitigation



Simple, In-Field  
Installation



High-Speed  
Impact Protection



Whole-Body  
Vibration Reduction



Durable and  
Long-Lasting

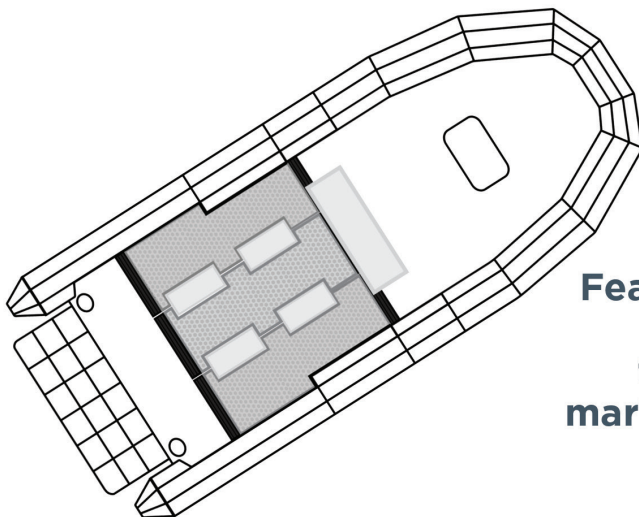
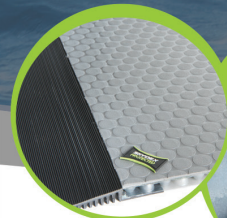

Features **SKYDEX** patented impact and cushioning technology trusted by boat builders and marine craft users for over a decade.

[www.SKYDEX.com](http://www.SKYDEX.com)

# DINGHY, TRANSOM & RUDDER

Our rudder fittings are renowned as being the best in the world. Tough, lightweight and durable they remain the no.1 choice for performance dinghy builders and sailors alike.

In this section you will find everything you need for steering any Dinghy, Sportsboat, Dayboat or small keelboat.

We manufacture over 120 different designs of Rudder Stock. Please enquire to see our full range.



**DESIGNED AND MANUFACTURED BY SEASURE**

# TILLER LOCK

The new version maintains the rugged reliability of the original and brings the design fully up to date.

- New design suitable for any tiller steered yacht or sports boat.
- Simple mechanism allows tiller to be set and adjusted – indispensable for short-handed sailing.
- Innovative design incorporates snubber which holds far better course than simply lashing tiller.

P/No	DESCRIPTION
19-27	Tiller Lock



A variety of methods for fixing or locking the tiller have been used over the years and many have only been adequate. Improvements in performance involving short keels and dagger rudders - often transom hung - suffer from an unfortunate handicap. With no skeg, no shelf, but with a sensitive rudder a boat will fall off her elegant balancing act if the helmsman lets go of the tiller. The increased sensitivity and faster response of newer boat designs calls for a better system. Such a system should:

1. Allow precise locking of the tiller with minimum difficulty.
2. Be quick and simple to operate when locking and particularly when releasing.
3. If possible, the system should be able to be detached instantly from the tiller in the event of any emergency.

The **TILLER LOCK** rope lock was designed to meet these points.

The device consists of a sheave and lever cam with a toothed slider mounted in a block which is fitted beneath the tiller. The rope is fitted across the after part of the cockpit with a means of keeping it under tension. When locked on to the rope the toothed slider prevents the tiller from moving in either direction.

Releasing the lock (by turning the lever to port) immediately frees the tiller and allows the rope to ride freely over the sheave for manual steering. In an emergency or when the device is not required, the rope can easily be snapped out of the block by a downward pull, clearing the tiller.



# 8mm (5/16") TRANSOM FITTINGS

The choice of champions! Fitted by top sailors around the world, when only the best will do. SeaSure rudder fittings are precision machined, tough, reliable and lightweight. Both pintles and gudgeons are manufactured from a heat treated corrosion resistant aluminium alloy, with hard grey finish for complete protection. Precision machining and optional low friction carbon bushes eliminate undesirable play in the rudder system. Pintles are brackered for added rigidity and absolute security. Spare bushes (part number: 18-39) are available for gudgeons.

Use packing pieces to achieve correct stock size (shown opposite).

- Range of sizes to fit many types of dinghies.

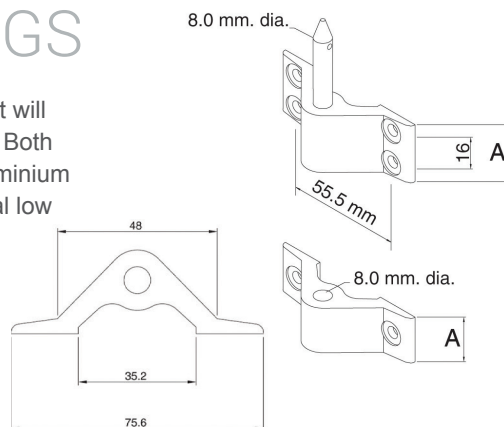

P/No	DESCRIPTION	Dim A
18-12	Top transom gudgeon, 2 hole mounting 6mm dia mounting holes	22mm
18-12B	Top transom gudgeon, 2-hole mounting 6mm dia mounting holes, with carbon bush	22mm
18-13	Top transom pintle, 2-hole mounting 6mm dia mounting holes	22mm
18-14	Bottom transom pintle, 4-hole mounting 5mm dia mounting holes	29mm
18-15	Bottom transom gudgeon, 4-hole mounting 5mm dia mounting holes	29mm
18-15B	Bottom transom gudgeon, 4-hole mounting 5mm dia mounting holes, with carbon bush	29mm
18-16	Top transom gudgeon, 2-hole mounting 5mm dia mounting holes	22mm
18-16B	Top transom gudgeon, 2-hole mounting, 5mm dia mounting holes, with carbon bush	22mm
18-17	Lightweight top transom gudgeon 2-hole mounting, 5mm dia mounting holes	13mm
18-18	Lightweight top transom pintle 2-hole mounting, 5mm dia mounting holes	13mm



18-12



18-12B



18-13



18-14



18-15



18-15B



18-16



18-16B



18-17



18-18

# 10mm (3/8") TRANSOM FITTINGS

P/No	DESCRIPTION
22.00	25mm Top Rudder Gudgeon
22.03	25mm Bottom Rudder Pintle
22.04	38mm Top Rudder Gudgeon
22.07	38mm Bottom Rudder Pintle
22.08	54mm Top Rudder Gudgeon
22.11	54mm Bottom Rudder Pintle

P/No	DESCRIPTION
22.12	Top Transom Gudgeon
22.13	Top Transom Pintle
22.14	Bottom Transom Pintle
22.15	Bottom Transom Gudgeon
22.44	32mm Top Rudder Pintle
22.45	32mm Bottom Rudder Gudgeon

# 8mm (5/16") RUDDER FITTINGS

- Fitted by Olympic and championship boat builders and sailors around the world. The choice of champions!
- Precision machined, tough, reliable, lightweight, and manufactured from heat treated corrosion resistant Aluminium alloy
- Hard Grey anodising with excellent scratch resistance compared with silver or black soft anodising
- Optional low friction carbon bushes eliminate play
- Pintles are cross pinned for rigidity and security
- Range of packing pieces to achieve correct width requirements

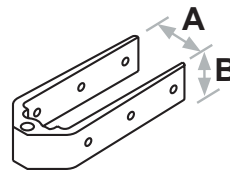

P/No	Dim A	Dim B
18-02	25mm	25mm
18-45	32mm	25mm
18-06	38mm	25mm
18-10	54mm	25mm



P/No	Dim A	Dim B
18-00	25mm	19mm
18-43	32mm	19mm
18-04	38mm	19mm
18-08	54mm	19mm



P/No	Dim A	Dim B
18-02B	25mm	25mm
18-45B	32mm	25mm
18-06B	38mm	25mm
18-10B	54mm	25mm



P/No	Dim A	Dim B
18-00B	25mm	19mm
18-43B	32mm	19mm
18-04B	38mm	19mm
18-08B	54mm	19mm



P/No	Dim A	Dim B
18-03	25mm	25mm
18-46	32mm	25mm
18-07	38mm	25mm
18-11	54mm	25mm



P/No	Dim A	Dim B
18-01	25mm	19mm
18-44	32mm	19mm
18-05	38mm	19mm
18-09	54mm	19mm

## RUDDER FITTINGS – 25MM (1")

P/No	DESCRIPTION	WEIGHT
18-00	Top rudder gudgeon, 2-hole mounting	47g
18-00B	Top rudder gudgeon, 2-hole mounting, with carbon bush	44g
18-01	Top rudder pintle, 2-hole mounting	65g
18-02	Bottom rudder gudgeon, 3-hole mounting	83g
18-02B	Bottom rudder gudgeon, 3-hole mounting, with carbon bush	80g
18-03	Bottom rudder pintle, 3-hole mounting	109g

## RUDDER FITTINGS – 38MM (1.5")

P/No	DESCRIPTION	WEIGHT
18-04	Top rudder gudgeon, 2-hole mounting	55g
18-04B	Top rudder gudgeon, 2-hole mounting, with carbon bush	55g
18-05	Top rudder pintle, 2-hole mounting	76g
18-06	Bottom rudder gudgeon, 3-hole mounting	96g
18-06B	Bottom rudder gudgeon, 3-hole mounting, with carbon bush	96g
18-07	Bottom rudder pintle, 3-hole mounting	123g

## RUDDER FITTINGS – 32MM (1.25")

P/No	DESCRIPTION	WEIGHT
18-43	Top rudder gudgeon, 2-hole mounting	56g
18-43B	Top rudder gudgeon, 2-hole mounting, with carbon bush	54g
18-44	Top rudder pintle, 2-hole mounting	75g
18-45	Bottom rudder gudgeon, 3-hole mounting	94g
18-45B	Bottom rudder gudgeon, 3-hole mounting, with carbon bush	92g
18-46	Bottom rudder pintle, 3-hole mounting	121g

## RUDDER FITTINGS – 54MM (2.125")

P/No	DESCRIPTION	WEIGHT
18-08	Top rudder gudgeon, 2-hole mounting	57g
18-08B	Top rudder gudgeon, 2-hole mounting, with carbon bush	56g
18-09	Top rudder pintle, 2-hole mounting	76g
18-10	Bottom rudder gudgeon, 3-hole mounting	100g
18-10B	Bottom rudder gudgeon, 3-hole mounting, with carbon bush	97g
18-11	Bottom rudder pintle, 3-hole mounting	127g

# RUDDER ACCESSORIES

- Rudder retaining clips manufactured with 316 stainless steel and moulded on end caps for ease of removal of the rudder.
- Wing nuts manufactured from 316 Stainless steel or black nylon for ease of tightening up the blade pivot bolt.
- Spare carbon gudgeon bush
- R clip

P/No	DESCRIPTION
18-19	Plastic rudder retaining clip
18-20	Stainless steel rudder retaining clip, 0.6mm material
18-21	Stainless steel rudder retaining clip, 1.0mm material
18-26P	Black nylon wing nut, M6
18-28P	Black nylon wing nut, M8
18-28	Stainless steel wing nut, M6
18-29	Stainless steel wing nut, M8
18-39	Spare carbon gudgeon bush
18-38	R clip

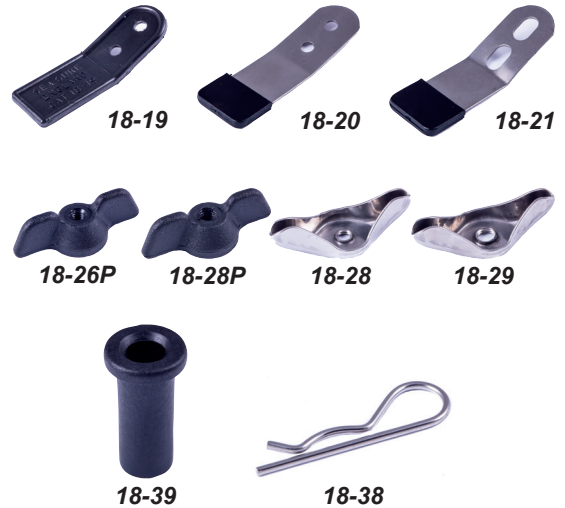

## PACKING PIECES

Ensure a tight fit between Blade/Transom and fittings

P/No	DESCRIPTION	THICKNESS
18-52	Transom packing piece, 2-hole	5.0mm
18-54	Transom packing piece, 4-hole	5.0mm



P/No	THICKNESS
18-33	6.3mm
18-35	1.8mm
18-36	3.2mm
18-37	5.0mm



P/No	THICKNESS
18-30	1.8mm
18-31	3.2mm
18-32	5.0mm
18-34	6.3mm

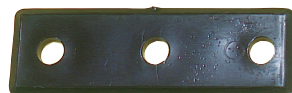

# ADJUSTABLE EXTENSIONS

## SURESTIK

Developed for sports boats and tiller-steered yachts, the SureStik has been designed for smooth adjustment and optimum strength to weight ratio.

Uniquely, these adjustable tiller extensions have the release button positioned in the top of the handle, so no need to take your eyes off the racing mark when adjusting the length. The use of Multiflex® for the ergonomically designed handle provides comfort for extended cruising and non-slip grip, even when wet. Now with straight handled version of this popular range.

P/No	DESCRIPTION	CLOSED	OPEN
23-36LB	Adjustable tiller extension, long, blue	65cm	85cm
23-36SB	Adjustable tiller extension, short, blue	52cm	72cm
23-36BLK	Adjustable tiller extension, long, black	65cm	85cm
23-36SBLK	Adjustable tiller extension, short, black	52cm	72cm
23-38BLU	Adjustable tiller extension, short, blue	52cm	72cm
23-38BLK	Adjustable tiller extension, short, black	52cm	72cm

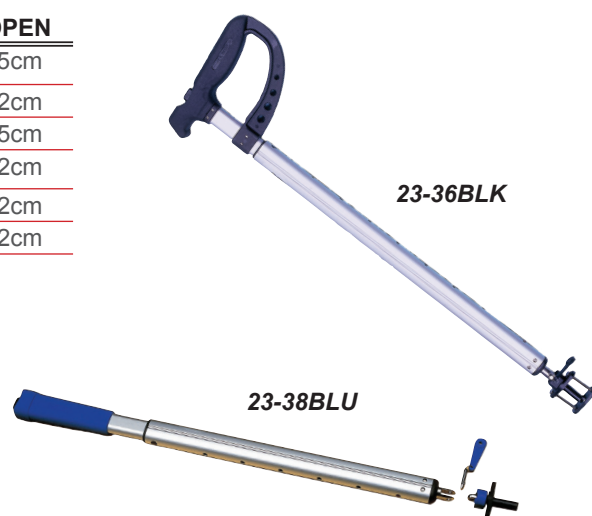

## CRUISER TELESCOPIC TILLER EXTENSION

P/No	CLOSED LENGTH	OPEN LENGTH
23-72	71cm	102cm



# TILLER EXTENSIONS 16mm Diameter

SeaSure have been at the forefront of tiller extension design for many years. We were first to introduce the all plastic joint following extensive research and development. Since then it has been copied by many but never equalled for quality or reliability.



## ALUMINIUM TILLER EXTENSION

P/No	LENGTH	BOATS
<b>Aluminium</b>		
23-32A	61cm	Optimist, Cadet
23-32B	110cm	RS200
23-32C	120cm	Finn, 420, 470, RS400
23-32D	130cm	Laser
23-32E	210cm	RS600, RS800
23-32F	220cm	B14
23-32G	230cm	RS700
23-32H	250cm	49er

Aluminium with long ribbed handle and fitted with SeaSure quick release kit – other type of joint available on request. Tube diameter: 16mm

## DINGHY TELESCOPIC TILLER EXTENSION

P/No	CLOSED LENGTH	OPEN LENGTH
23-70A	71cm	102cm
23-70B	81cm	123cm
23-70C	102cm	163cm

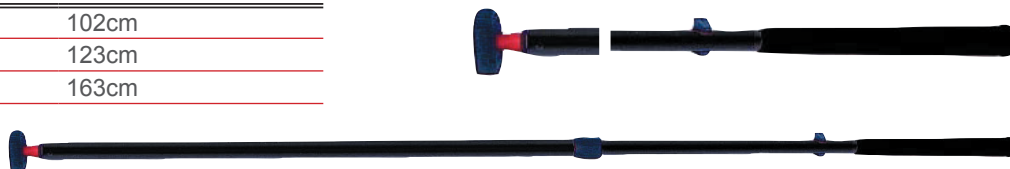

## ALUMINIUM TILLER

P/No	DESCRIPTION
23-50	Strong but lightweight tiller designed to fit a number of stocks, including the standard Laser rudder stock assembly

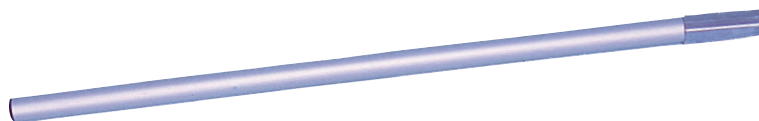

# TILLER EXTENSION ACCESSORIES

P/No	DESCRIPTION
23-41	Saddle for 25mm (1") tube
23-43	Saddle for 32mm (1.25") tube
23-45	Plastic clamp plate
23-46	25mm (1") tube saddle for clip
23-47	32mm (1.25") tube saddle for clip
23-40	Clip to suit 16mm (5/8") o/d tiller extension
23-84	Clip to suit 19mm (3/4") o/d tiller extension
23-86	Clip to suit 22mm (7/8") o/d tiller extension
23-87	Clip to suit 25mm (1") o/d tiller extension



# TILLER EXTENSION END SETS

Contact for more information...

P/No	DESCRIPTION	ID TUBE
23-67	Extra flexible end set (no ridges)	14mm
23-67A	Extra flexible end set	13.5mm
23-44	Standard Flexible End Set inc Rivet	
23-76	Quick Release Kit	13.5mm
23-77	Composite universal joint	13.5mm
23-78	Slick Release	13.5mm



# TILLER EXTENSION JOINT KITS

P/No	DESCRIPTION
23.65CRD	Standard Joint kit
23.65DCRD	Standard joint kit with rope core
23.67ACRD	Extra Flexible End Set Kit
23.67DCRD	Extra Flexible joint with rope core kit
23.77CRD	Composite Universal tiller extension joint kit
23.76CRD	Standard joint and twist off base kit
23.76DCRD	Standard joint with rope core and twist off base kit
23.79CRD	Standard joint and Slick Release base kit
23.79DCRD	Standard joint with rope core and Slick Release base kit
23.80CRD	Extra Flexible joint and twist off base kit
23.80DCRD	Extra Flexible joint with rope core and twist off base kit
23.81CRD	Standard Joint and mounting base
23.81DCRD	Standard Joint with rope core and mounting base
23.82CRD	Extra Flexible joint and mounting base
23.82DCRD	Extra Flexible joint with rope core and mounting base
23.83CRD	Extra Flexible joint and Slick Release base kit
23.83DCRD	Extra Flexible joint with rope core and Slick Release base kit



# TRAPEZE GEAR

SeaSure manufactures a wide range of trapeze gear to suit all types of dinghy and levels of ability. Our new range of handles, rings and hooks extends the range still further. The wide number of options available means that you can design the arrangement which most suits you and your boat. The new button grips are available in two sizes and six different colour combinations for increased colour co-ordination within the boat. Electro-polished 316 Stainless steel is used throughout the range to ensure that the highest degree of corrosion resistance is achieved.

## TRAPEZE HANDLES

**19-35 & 19-35A** Strong and simple open handle features tubular up-stand for comfortable use on wire. Can be supplied with or without a becket for fitting adjustment gear directly below handle.

**19-37 & 19-37A** Strong, comfortable and lightweight. They are manufactured from stainless steel with a wide power-grip handle.

They can be supplied with or without sheaves depending on your trapeze arrangement.

**19-31 & 19-32** A new range of simple and very light weight handles available in six colours and either 52mm diameter or 65mm diameter to suit different hand sizes.



## TRAPEZE RINGS

**19-30** Two-position ring with central bar to attach shock cord that ensures the ring is held in the correct position ready for use. Weight: 75g.

**19-33** Similar to 19-30 but with parallel "grab" section and angled for ease of hooking on. Weight: 60g.

**19-34** A compact lightweight ring with built in sheave for use on continuously adjustable systems. Weight: 50g.

**19-29** New wide end for maximum hook target. It has a central shock cord bar and is angled to put it in position and directly to hand. There is also a parallel section for ease of handling. Weight: 64g



## COMPLETE TRAPEZE SET

**19-38** Complete trapeze set, ready to fit trapeze wire and retaining shock-cord. Set comprises 19-37A, 19-34, 00-13 and spliced terylene line.

**19-45** High performance trapeze set. Set comprises 19-35, 19-34, cleat and 1.5m high performance rope.



# SUPERSUCK BAILER

Few dinghies can sail fast enough to windward, particularly in rough weather or half full of water, for a wedge type bailer to operate well.

Based on the venturi principle the Supersuck bailer literally sucks the water from the boat even at low speeds. It has a higher pumping capacity than traditional bailers and creates less drag. This means you have a lighter boat which accelerates more quickly than the opposition giving real race advantage.

The bailers have a robust construction, using 316 stainless steel and high grade plastics for a long trouble free life.  
Weights: 187g (19-90); 220g (19-92)

Note:

Seal kit for 19-90 externally mounted bailer is 19-93 (seal only).

Seal kit for 19-92 internally mounted bailer is 19-91 (seal kit & gasket).

**Internally and externally mounted versions available.**

**Simple and efficient**

P/No	DESCRIPTION
19-90	Externally mounted bailer
19-91	Spare seal kit for 19-92
19-92	Internally mounted bailer
19-93	Spare seal kit for 19-90

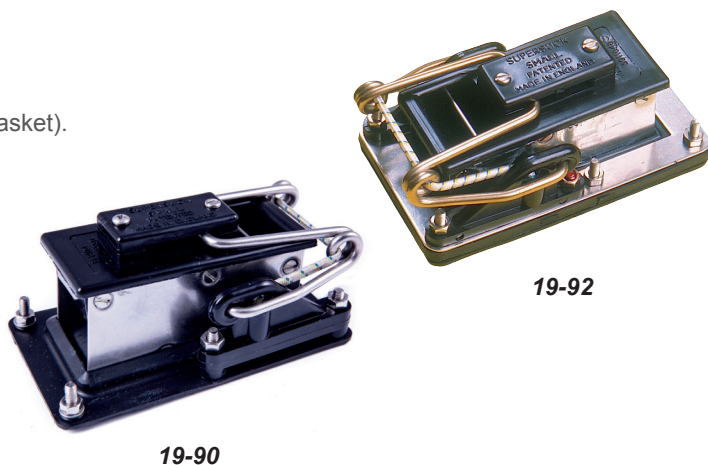

# FURLERS

The SeaSure jib furler is designed for complete reliability. The drum is completely enclosed to prevent rope from coming off and jamming during operation. It also features an all stainless steel thrust bearing so that it still operates easily when the forestay is fully tensioned. Being less than 50mm between centres allows the jib to be set very low to the deck for maximum sail efficiency. It can also be mounted below the deck using an additional stainless steel extension tube. The furler will take up to 3.5m of 3mm line allowing it to be used on sails with a foot length of approximately 3m (this is reduced if larger diameter line is used). Drum Diameter: 69mm Weight: 116g (25-54)

Our head swivels are fitted with stainless steel balls and bronze seats for low friction and long life. They are available in two sizes and are fitted with anti chafe inserts for added sail protection. Weights: 53g (25-57); 48g (25-57A)

P/No	DESCRIPTION
25-54	Dinghy jib furler
25-57	Head swivel with 4mm top slot
25-57A	Head swivel with 6.5mm top slot
25-58	Spare casing for 25-54

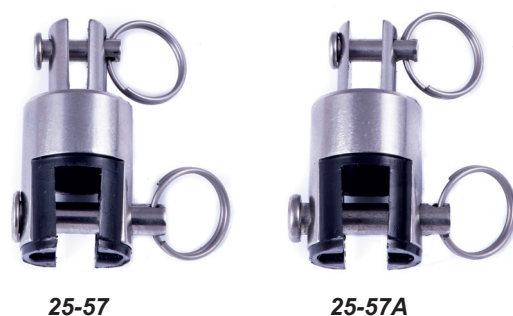

# TACK BAR FURLER

The Tack Bar Furler combines 2 fittings into 1 combining SeaSure's bronze and stainless thrust bearing jib furler reliability, with a smooth snag free spinnaker chute entrance.





## HATCH COVERS

These are high quality strong hatch covers. They are fitted with an "O" ring seal which provides an excellent waterproof fitting when the lid is screwed on. The outer flange has ample strength with a ribbed underside for mastic sealant.



P/No	DESCRIPTION
18-70B	110mm (4") black cover complete with 'O' ring
18-70W	110mm (4") white cover complete with 'O' ring
18-71	110mm (4") 'O' ring
18-72B	157mm (5") black cover complete with 'O' ring

P/No	DESCRIPTION
18-72W	157mm (5") white cover complete with 'O' ring
18-73	157mm (5") 'O' ring
18-76	110mm (4") clear cover complete with 'O' ring
18-78	157mm (5") clear cover complete with 'O' ring

## SHROUD ADJUSTERS

P/No	DESCRIPTION	DIM 'A'	DIM 'B'	HOLE DIAMETER
25-41	Adjusts from 60mm to 95mm in 5 steps	96mm	11mm	4mm
27-25	Adjusts from 30mm to 70mm in 5 steps	68mm	7mm	4mm

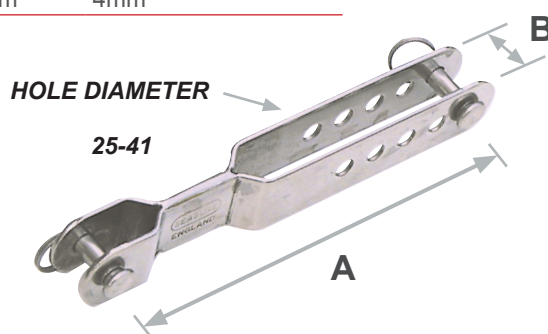

## 3 HOLE VERNIERS

Race developed for the skiff market.

- Allows far more adjustment to be made to the caps and lowers without crossing or interference.
- Feature a reinforced base for added strength.
- Supplied with fast-pins for ease of adjustment on the water.

P/No	DESCRIPTION
27.10	Hole shroud vernier



# SPINNAKER POLE FITTINGS

A truly robust range of end fittings. Fabricated from 316 stainless steel they are very durable and capable of survival even in the toughest conditions.



16-07 16-09 16-11



16-21



16-29



16-31



16-33



16-23



16-25

P/No	DESCRIPTION	WEIGHT
16-07	Spinnaker pole end to fit 25mm o/d tube	96g
16-09	Spinnaker pole end to fit 32mm o/d tube	105g
16-11	Tapered spinnaker pole end to fit wooden pole (32mm at large end)	94g
16-21	Centre cleat	6g
16-29	Keyhole ring for up-haul / down-haul on 25 or 32mm dia. poles	14g
16-31	Keyhole ring for up-haul / down-haul fitting for 38mm dia. poles	14g
16-23	Trip Grip for 25mm dia. poles	24g
16-25	Trip Grip for 32mm dia. poles	18g
16-33	Trigger Grip for tapered or parallel wooden or aluminium poles up to 38mm o/d	11g

# SPINNAKER GUY HOOKS

*Positioned close to the shrouds, these hooks retain the spinnaker guy when reaching or running.*

P/No	DESCRIPTION
16-13	Spinnaker guy hook
16-15	Spinnaker guy hook with integral bolt
25-92	Spare rubber for 16-13 & 16-15

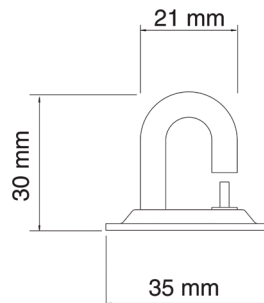

16-13



25-92



16-15

## SISTER HOOKS

These innovative self locking hooks which have numerous applications for either racing or cruising.

- Manufactured from 316 stainless steel for strength and corrosion resistance.
- Used as replacements for quick links and shackles where fast disconnection is needed.

<b>P/No</b>	<b>OVERALL LENGTH</b>
16.42	25mm
16.44	31mm
16.46	38mm
16.48	50mm

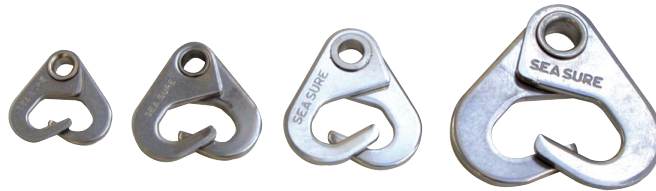

## SAIL FEEDERS

Sail feeders available to suit 6, 8 and 12mm luff bolt rope. The aluminium rollers guide the bolt rope into the mast groove eliminating twisting or snagging, making mainsail hoisting a one man operation.

<b>P/No</b>	<b>DESCRIPTION</b>	<b>DIMENSIONS</b>	<b>MAX LUFF DIA</b>
05-44	Sail feeder with backing bar	M5 Screws Clamping bar dia. 9.5m	12mm
05-43	Dinghy sail feeder	45mm	8mm
05-42	Dinghy sail feeder	42mm	8mm
05-41	Dinghy sail feeder	45mm	6mm
05-40	Dinghy sail feeder	42mm	6mm



**05-44**

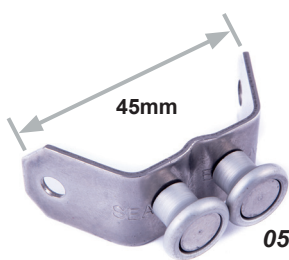

**05-43/05-41**

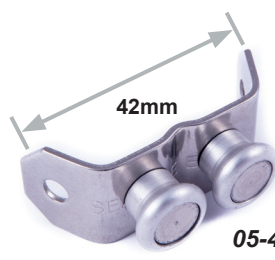

**05-42/05-40**

# KICKING STRAP SETS

A complete range of multi-part sets complete with stainless steel key, plastic covered wire strop and parrel bead.

They are reeved with 6mm rope spliced on and ready to go!

P/No	DESCRIPTION
00-62	2:1 purchase
00-63	3:1 purchase
00-64	4:1 purchase
00-65	5:1 purchase
00-66	6:1 purchase
05-01	Kicking strap key

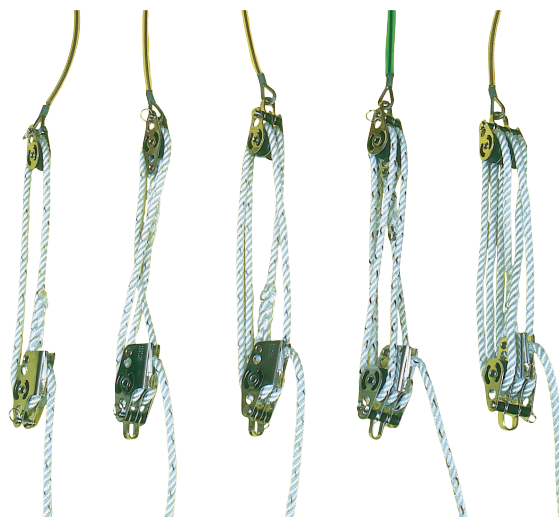

# EYE PLATES

Our range of deck eyes, clips and hooks are manufactured from top grade AISI 316 stainless steel. They undergo multiple machining and finishing operations to ensure they have a smooth finish and are free of damaging sharp corners and burrs.



P/No	DESCRIPTION	PLATE SIZE (mm)	PLATE THICKNESS (mm)	EYE MATERIAL DIA. (mm)	FIXING HOLE DIA. (mm)
16-35	Dinghy boom slider	16 x 59	2.5	5.0	M5 screw
16-01	Dinghy mast plate - horizontal eye	44 x 51	1.5	6.3	5.0
16-03	Dinghy mast plate - vertical eye	42 x 50	1.5	6.3	5.0
16-05	Flat eye plate	41 x 51	1.5	6.0	5.0
16-05B	Nest plate for 16-05				

# TRAPEZE HOOKS

P/No	DESCRIPTION	WEIGHT
19-39	Lace-up trapeze hook	151g
19-40	Spreader bar for 50mm webbing	293g
19-40A	Spreader bar for 40mm webbing	273g
25-93	Spare rubber for trapeze hooks	13.5mm



**19-39**

Lace-up hooks allow considerable adjustment for extra comfort. Manufactured from electro-polished 316 stainless steel the hook has a reinforced web for maximum strength.

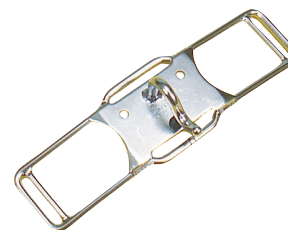
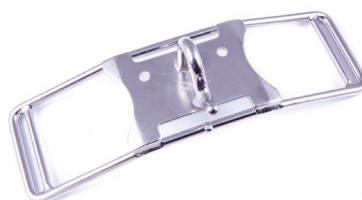

**19-40 & 19-40A**

These strong and lightweight spreader bars improve comfort when hiking out and allow for ease of adjustment. Suitable for 50mm and 40mm webbing.

# ROPE STOPS/BALL STOPS

A complete range of 4 sizes and 6 colours so that control lines within the boat can be colour coded. They are counter bored one end to take a stopper knot. Available in Black, Red, Yellow, Green, Blue and White.



**17mm**

**BEAD DIAMETER**



**22mm**

**BEAD DIAMETER**



**32mm**

**BEAD DIAMETER**



**44mm**

**BEAD DIAMETER**

P/No	MAX ROPE SIZE
25-31 BLK	5mm
25-31 RED	5mm
25-31 YEL	5mm
25-31 GRN	5mm
25-31 BLU	5mm
25-31 WHI	5mm

P/No	MAX ROPE SIZE
25-35 BLK	6mm
25-35 RED	6mm
25-35 YEL	6mm
25-35 GRN	6mm
25-35 BLU	6mm
25-35 WHI	6mm

P/No	MAX ROPE SIZE
25-36 BLK	7mm
25-36 RED	7mm
25-36 YEL	7mm
25-36 GRN	7mm
25-36 BLU	7mm
25-36 WHI	7mm

P/No	MAX ROPE SIZE
25-46 BLK	11mm
25-46 RED	11mm
25-46 YEL	11mm
25-46 GRN	11mm
25-46 BLU	11mm
25-46 WHI	11mm

# YACHT, SAIL, RIG, DECK & MANUFACTURING

For more than 50 years we have been designing, developing and manufacturing at our ISO9001 certified production facility in Hampshire, UK. We produce a wide range of high performance stainless steel, aluminium, plastic and carbon hardware for the marine and aerospace industries.

With a dedicated research and development team and the aid of 3D CAD software, we are able to develop ideas and then produce reliable, innovative and world class products.

With many design awards nominations in recent years, we believe the high standards of design, engineering and manufacturing we strive for have been recognised.



DESIGNED AND MANUFACTURED BY SEASURE

## 316 STAINLESS STEEL WIRE 1 X 19

High quality Stainless Steel wire for all marine and outdoor applications. 1 x 19 construction is low stretch and ideal for all standing rigging applications such as shrouds, forestays and guardrails.

PART NO.	TYPE	SIZE DIAM	REEL LENGTH
42.00 eu	1 x 19	2mm	250m
42.01 eu	1 x 19	2.5mm	250m
42.02 eu	1 x 19	3mm	250m
42.03 eu	1 x 19	4mm	250m
42.04 eu	1 x 19	5mm	250m
42.05 eu	1 x 19	6mm	250m
42.06 eu	1 x 19	7mm	250m
42.07 eu	1 x 19	8mm	250m
42.08 eu	1 x 19	10mm	250m

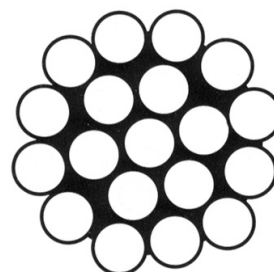

## 316 STAINLESS STEEL WIRE 7 X 19

High quality flexible Stainless Steel wire for all marine and outdoor applications. 7 x 19 construction is designed for maximum flexibility with low stretch. Ideal for halyards or wire control lines using metal sheave blocks.

PART NO.	TYPE	SIZE DIAM	REEL LENGTH
42.09 eu	7 x 19	2mm	250m
42.10 eu	7 x 19	2.5mm	250m
42.11 eu	7 x 19	3mm	250m
42.12 eu	7 x 19	3.5mm	250m
42.13 eu	7 x 19	4mm	250m
42.14 eu	7 x 19	5mm	250m
42.15 eu	7 x 19	6mm	250m
42.16 eu	7 x 19	7mm	250m
42.17 eu	7 x 19	8mm	250m
42.18 eu	7 x 19	10mm	250m

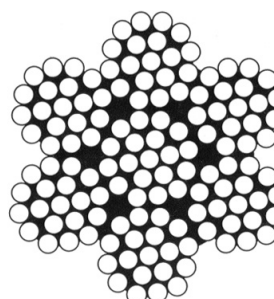

## SMALL NICOPRESS HAND TOOL

P/No	DESCRIPTION
10-00/07	Small hand tool to swage ferrules onto 2mm and 2.5mm diameter wire.



# NICOPRESS TOOLS

**Nicopress**

Our extensive range of Nicopress tools and ferrules allow quick and simple termination or eye splicing of wire and synthetic ropes. The system is well proven, having been used in the aviation and yachting industry for 50 years.

Ferrules are available in zinc plated copper for use with stainless steel cable, or in aluminium for use with galvanised steel cable.

Either bench or hand tools can be used to terminate the ferrules, and with all but the small hand tool, various heads can be fitted to the handles to accommodate differing ferrule sizes.

NOTE: A good Nicopress swage will be 95% of the strength of the wires breaking load.



10-04

HEAD P/No SeaSure	CROSS REFERENCE Nicopress
10-08	51-B4-887
10.09	51-C-887
10.10	51-G-887
10.11	51-M-850
10.12	51-P-850
10.13	51-X-850
10.14	51-F2-850
10.15	64-CGMP
10.16	63V-XPM
10.21	51-MJ

COMPLETE TOOL	BENCH TOOL WITHOUT HEAD	TO SUIT WIRE DIAMETER						
		1mm	2mm	2.5mm	3mm	4mm	5mm	6mm
10-08	10-04	.						
10-09	10-04		.					
10-10	10-04			.				
10-11	10-04				.			
10-12	10-04					.		
10-13	10-04						.	
10-14	10-04							.
10-15	10-04		.	.	.	.		
10-16	10-04							
10-21	Head for copper sleeves			.	.	.		

# NICOPRESS FERRULES

ZINC PLATED COPPER FOR STAINLESS WIRE	ALUMINIUM FOR GALVANISED WIRE	TO SUIT WIRE DIA						
		1mm	2mm	2.5mm	3mm	4mm	5mm	6mm
10-30	10-40	.						
10-31	10-41		.					
10-32	10-41			.				
10-33	10-42				.			
10-34	10-43					.		
10-35	10-44						.	
10-36								.

aluminium  
ferrulescopper  
ferrulescopper stop  
sleeves

P/No	TO SUIT WIRE DIA	SWAGING HEAD
10-22	1.5mm	10-09
10-23	2mm	10-09
10-24	2.5mm	10-21
10-25	3mm	10-21
10-26	4mm	10-21



# RIVETERS AND RIVETS

P/No	DESCRIPTION
11-19	Heavy duty riveter, suitable for 5/32", 3/16" and 1/4" monel pop rivets.
11-19A	Draper riveter, suitable for 5/32", 3/16" and 1/4" monel pop rivets.
11-21	Heavy duty riveter kit. Spiralux riveter supplied with approx. 190 rivets (1/8" x 1/4" lg, 1/8" x 3/8" lg, 5/32" x 3/8" lg and 3/16" x 3/8" lg)



11-19A



11-21

## RIVETERS SPARE KITS

P/No	DESCRIPTION
11-10	Spare frame head for riveter part number 11-19
11-11	Spare nose piece, riveter part no. 11-19 (1/4" rivets)
11-20	Spare jaws for riveter part number 11-19
11-22	Spare nose piece, riveter part no. 11-19 (3/16" rivets)
11-23	Spare nose piece, riveter part no. 11-19 (5/32" rivets)
11-24	Spare nose piece, riveter part no. 11-19 (1/8" rivets)
11-17	Spares kit for riveter part number 11-21
11-18	Nozzle kit for riveter part number 11-21



11-34

## MONEL POP RIVETS

P/No	DIA.	LENGTH	P/No	DIA.	LENGTH
11-30	1/8"	3.18mm 1/4" 6.35mm	11-35	3/16"	4.8mm 3/4" 19.5mm
11-31	1/8"	3.18mm 3/8" 9.54mm	11-36	3/16"	4.8mm 5/8" 15.9mm
11-32	5/32"	3.97mm 3/8" 9.54mm	11-37	1/4"	6.35mm 1/2" 12.7mm
11-33	3/16"	4.8mm 3/8" 9.54mm	11-38	1/4"	6.35mm 3/4" 19.2mm
11-34	3/16"	4.8mm 1/2" 12.7mm			

# FELCO CUTTERS

Manufactured in Switzerland, Felco wire cutters are generally recognised as being the best available.



11-00

11-01

11-02

11-05

11-08

11-12

### CUTTING CAPACITY

P/No	DESCRIPTION	CUTTING CAPACITY		
		316 Stainless Wire	Python wire	Galvanised steel
11-00	Felco C7 cutters	5mm	4mm	6mm
11-01	Felco C9 cutters	6mm	5mm	8mm
11-02	Felco C12 cutters	6mm	5mm	10mm
11-03	Spare head for C12 cutters	-	-	-
11-04	Bolt for C12 cutters	-	-	-
11-05	Felco C16 cutters	7mm	6mm	14mm
11-06	Spare head for C16 cutters	-	-	-
11-07	Bolt for C16 cutters	-	-	-
11-08	Felco C108 geared-head cutters	8mm	8mm	8mm
11-09	Spare blades for C108 cutters	-	-	-
11-12	Felco C112 cutters	12.7mm	12.7mm	12.7mm

# INNER FORESTAY LEVER

Fabricated from 316 stainless steel this well tested reliable design is tough and strong.

As well as being used for inner forestays they can also be used as a safety device on boats fitted with furling head sails allowing a storm jib to be flown in an emergency.

Essential for fast assembly of inner forestays in bad weather conditions.

Uses

- Inner/Emergency forestays
- Security tenders and lifeboats

P/No	21-40	21-42
WIRE DIA.	6mm	8mm
LENGTH OPEN	380mm	514mm
LENGTH CLOSED	260mm	375mm
PIN SIZE	10mm	12mm
THREAD	10mm	12mm
MIN. BREAKING LOAD	2100Kg	4100Kg



# HIGHFIELD LEVER

A robust lever in stainless steel with 50mm total throw and 5 position adjuster. The long handle allows easy adjustment even under considerable loads.

P/No	DESCRIPTION	PIN DIAMETER
25-40	Highfield lever	6mm

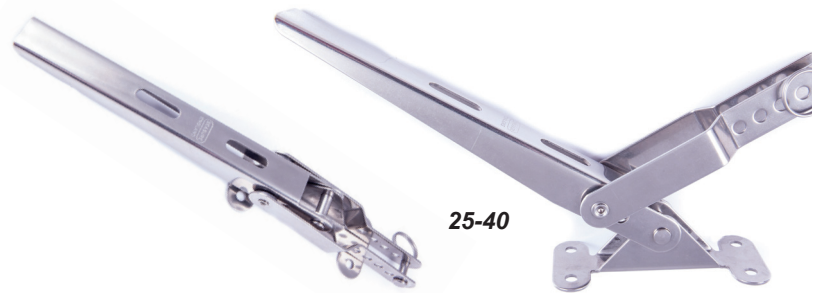

# TURNBUCKLE

P/No	DESCRIPTION	
27-20	Tensioning turnbuckle.	Closed length=73mm Open length=146mm



# SHROUD ADJUSTERS

P/No	DESCRIPTION	DIM 'A'	DIM 'B'	HOLE DIAMETER
25-41	Adjusts from 60mm to 95mm in 5 steps	96mm	11mm	4mm
27-25	Adjusts from 30mm to 70mm in 5 steps	68mm	7mm	4mm

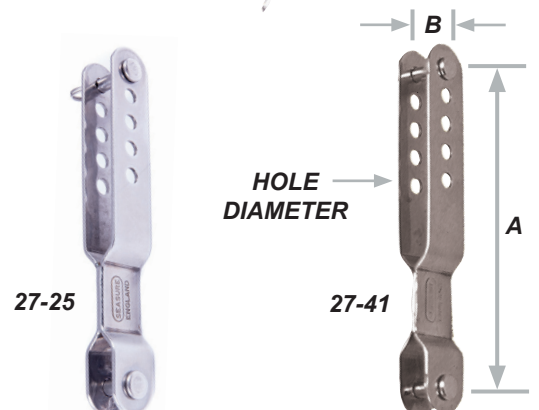

# SOLID STAINLESS STEEL THIMBLES

All thimbles are manufactured from 316 stainless steel and are available in a wide range of sizes and styles to meet most applications.

P/No	NOMINAL SCORE	LARGEST CIRCULAR APERTURE
06-86	4mm	10mm
06-88	6mm	12mm
06-90	8mm	15mm

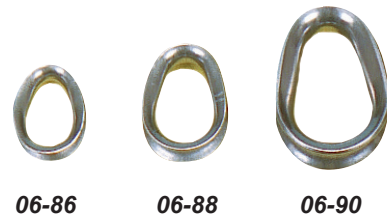

# OPEN THIMBLES HEAVY DUTY

P/No	NOMINAL SCORE	MATERIAL THICKNESS	NOMINAL LENGTH
11-70	2mm	1mm	23mm
11-71	3mm	1mm	25mm
11-72	4mm	1mm	25mm
11-73	5mm	1mm	32mm
11-74	6mm	1.2mm	39mm
11-76	8mm	1.5mm	48mm



# OPEN THIMBLES LIGHT DUTY

P/No	NOMINAL SCORE	MATERIAL THICKNESS	NOMINAL LENGTH
11-42	2mm	0.6mm	24mm
11-43	3mm	0.6mm	28mm
11-44	4mm	0.6mm	36mm
11-45	5mm	1mm	42mm
11-46	6mm	1.2mm	51mm



# THIMBLE BUTTON

Triangular plate for use with split backstays or twin forestays

P/No	DESCRIPTION
27-04	For 2 - 5mm wire

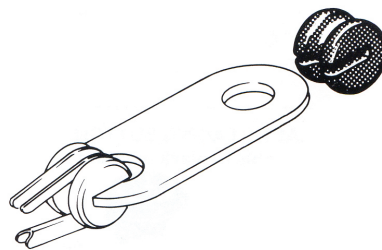

27-04

# BUDGET THIMBLES

P/No	SCORE	LENGTH
40-93	3mm	20mm
40-94	3mm	25mm
40-95	3mm	28mm
40-96	3mm	31mm
40-99	3mm	42mm
41-00	3mm	45mm
41-03	3mm	52mm



## DUPLEX WIRE ROPE GRIPS

P/No	WIRE SIZE
11-60	2mm
11-61	3mm
11-62	4mm
11-63	5mm



## BUDGET WIRE ROPE GRIPS

P/No	To Suit Wire Dia
41.19	5mm
41.20	6mm
41.21	8mm



## BUDGET PELICAN HOOK

Pelican Hook    Stainless Steel

P/No	Overall Length	To Suit
41.22	76mm	M6
41.23	102mm	M8
41.24	127mm	M10



## BUDGET TURNBUCKLES

Closed Body Fork/Fork Stainless Steel

P/No	Pin Dia	Thread size
41.29	6mm	M6
41.30	8mm	M8
41.31	9mm	M9



Open Body Fork/Fork

P/No	Pin Dia	Thread size
41.25	6mm	M6
41.26	8mm	M8
41.27	10mm	M10
41.28	12mm	M12



## BUDGET FORK SWAGE TERMINALS

P/No	Pin Dia	To Suit Wire Dia.
41.32	6mm	3mm
41.33	8mm	4mm
41.34	9mm	5mm
41.35	12mm	6mm
41.36	14mm	8mm



## BUDGET EYE & STUD SWAGE TERMINALS

P/No	To Suit Wire Dia.
41.37	3mm
41.38	4mm
41.39	5mm
41.40	6mm
41.41	8mm



P/No	Thread	To Suit Wire Dia.
41.42	M6	3mm
41.43	M8	4mm
41.44	M9	5mm
41.45	M12	6mm
41.46	M14	8mm



## FORK AND EYE TOGGLES

Stainless steel toggles supplied with clevis pins for fork ends. They are machined from solid 316 stainless steel for added strength.

P/No	DIM 'A' (HOLE CENTRES)	DIM 'B'	PIN DIA.
20-89	54mm	11mm	11mm
20-92	64mm	12.5mm	12.7mm

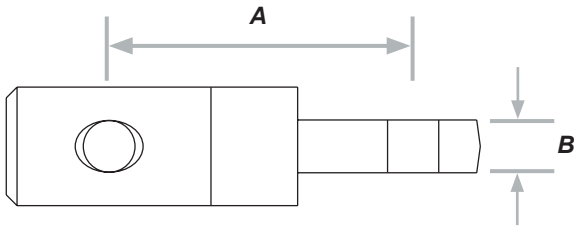

## FORK AND FORK TOGGLES

Stainless steel toggles supplied with clevis pins for fork ends. They are machined from solid 316 s/steel for added strength.

P/No	DIM 'A' (HOLE CENTRES)	DIM 'B'	PIN DIA.
21-28	38.1mm	8.5mm	8mm
21-30	53.3mm	9.5mm	9.5mm
21-32	50.8mm	11mm	11mm
21-34	57.2mm	14mm	12.7mm
21-36	57.2mm	15.5mm	15.9mm
21-38	69.9mm	19mm	19mm

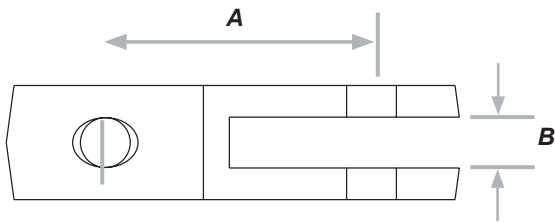

## TRIANGULAR PLATE

Triangular plate for use with split backstays or twin forestays

P/No	PLATE THICKNESS	HOLE PITCH	HOLE DIA.
20-96	2.6mm	51mm	11mm



# CLEW BLOCKS

SeaSure's range of clew blocks are unsurpassed for quality and performance. The bearing system has been engineered to provide smooth-running reliability under the most demanding conditions, whilst the aluminium alloy side plates provide strength without adding excessive weight. Also available in other colours.

Breaking Load available on our Website

*These Blocks are selected for the sails on the Global Challenge Round the World Race.*



P/No	SHEAVE DIA.	MAX ROPE SIZE	WEBBING SIZE	SUITABLE FOR BOATS
04-87	42mm	8mm	20mm	7 - 10 metres
04-88	50mm	10mm	30mm	7 - 12 metres
04-90	70mm	12mm	30mm	10 - 16 metres
04-92	100mm	14mm	50mm	14 - 18 metres



# REEFING BLOCKS

Product specification required.

Breaking Load available on our Website



P/No	SHEAVE DIA.	MAX ROPE SIZE	WEBBING SIZE	SUITABLE FOR BOATS
04-87RB	42mm	8mm	20mm	7 - 10 metres
04-88RB	50mm	10mm	30mm	7 - 12 metres
04-90RB	70mm	12mm	30mm	10 - 16 metres
04-92RB	100mm	14mm	50mm	14 - 18 metres

# SPECIAL CLEW RINGS

Electro-polished stainless steel clew rings specially designed to spread the load evenly around the clew area, preventing distortion of the tapes.

P/No	DIM 'A'	DIM 'B'
07-00	38mm	6.4mm
07-02	57mm	6.4mm
07-04	66mm	7.9mm
07-06	78mm	9.5mm
07-08	81mm	12.7mm

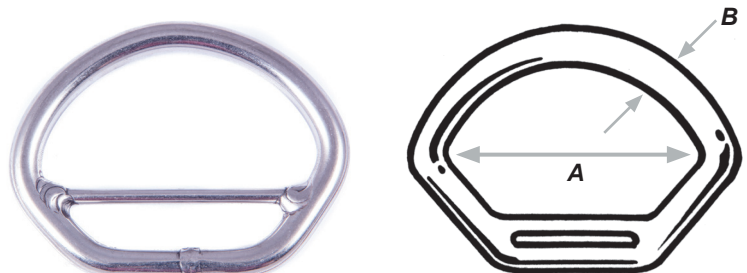

# RINGS

## BARREL FINISH STAINLESS STEEL RINGS Not electro polished

P/No	NOMINAL I/D	WIRE DIAMETER
17-00	15mm	3.2mm
17-02	12mm	2mm
17-03	20mm	4mm
17-05	25mm	4mm
17-07	20mm	5mm
17-09	25mm	5mm
17-11	30mm	5mm
17-13	30mm	6mm
17-15	40mm	6mm
17-17	50mm	6mm
17-19	30mm	8mm
17-21	40mm	8mm
17-23	50mm	8mm
17-25	60mm	8mm
17-27	75mm	8mm
17-29	50mm	10mm
17-31	60mm	10mm
17-33	75mm	10mm

Breaking Load available in the back of the catalogue. If the sizes or shapes that you require are not on this list, then we can manufacture bespoke batches. All SeaSure rings are FULL PENETRATION welded, this makes the weld as strong as the bar it self.

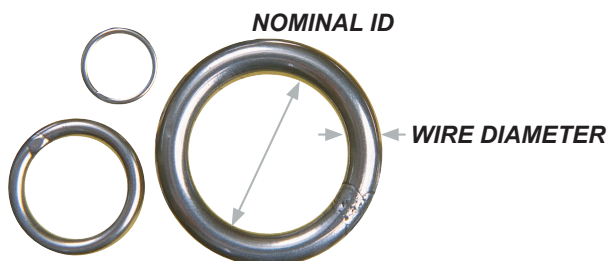

## ELECTRO-POLISHED STAINLESS STEEL RINGS

P/No	NOMINAL I/D	WIRE DIAMETER
07-10	15mm	3.2mm
07-12	19mm	4.0mm
07-14	25mm	4.0mm
07-16	31mm	4.8mm
07-18	31mm	6.3mm
07-19	31mm	8.0mm
07-20	37mm	6.3mm
07-21	38mm	8.0mm
07-22	44mm	6.3mm
07-23	44mm	8.0mm
07-24	51mm	6.3mm
07-25	51mm	8.0mm
07-26	57mm	6.3mm
07-27	57mm	8.0mm
07-28	63mm	8.0mm
07-30	70mm	8.0mm
07-31	76mm	9.5mm

## BUDGET RING STAINLESS STEEL

P/No	Material	Dia i/d
40.63	3mm	30mm
40.65	4mm	40mm
40.66	5mm	40mm



# D - RINGS

## ELECTRO-POLISHED STAINLESS STEEL D-RINGS

P/No	DIM 'A' NOMINAL	DIM 'B' NOMINAL	WIRE DIAMETER
07-43	25mm	20mm	4.8mm
07-44	27mm	20mm	4.0mm
07-45	19mm	16mm	4.0mm
07-45A	20mm	14mm	3.0mm
07-46	40mm	30mm	4.8mm
07-48	50mm	30mm	4.8mm
07-49	47mm	37mm	6.3mm
07-50	50mm	50mm	8.0mm



07-46



07-50

**BARREL FINISH STAINLESS STEEL D-RINGS** Not electro-polished

P/No	DIM 'A' NOMINAL	DIM 'B' NOMINAL	WIRE DIAMETER
17-40	25mm	17mm	5mm
17-43	35mm	28mm	5mm
17-45	40mm	25mm	5mm
17-47	45mm	33mm	5mm
17-49	50mm	35mm	5mm

P/No	DIM 'A' NOMINAL	DIM 'B' NOMINAL	WIRE DIAMETER
17-51	50mm	34mm	6mm
17-53	60mm	31mm	6mm
17-55	60mm	52mm	8mm
17-57	60mm	52mm	8mm with 4mm bar

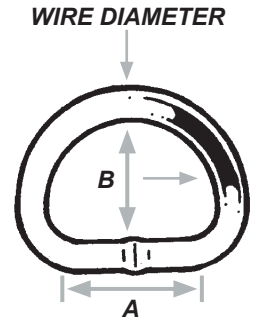
**ELECTRO POLISHED D-RINGS WITH BAR**

Very strong for all types of applications using webbing straps:  
Sails & covers, harnesses, bags, etc.

P/No	DIM 'A'	WIRE DIAMETER
07-86	60mm	8mm

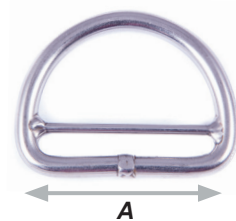
**TRIANGLES****ELECTRO-POLISHED STAINLESS STEEL TRIANGLES**

P/No WITHOUT BAR	P/No WITH BAR	DIM 'A' NOMINAL	DIM 'B' NOMINAL	WIRE DIAMETER
07-32	07-34	50mm	45mm	6.3mm
07-36	07-38	65mm	50mm	8.0mm
07-40	07-42	85mm	68mm	9.5mm
07-52	n/a	30mm	50mm	4.8mm
07-54	n/a	42mm	67mm	6.3mm
07-55	n/a	27mm	25mm	4.8mm
07-56	n/a	30mm	28mm	6.3mm
07-57	n/a	36mm	34mm	5.0mm
07-58	n/a	36mm	34mm	6.0mm
08-14	n/a	45mm	45mm	6.3mm
08-20	n/a	55mm	48mm	8.0mm

**BARREL FINISH STAINLESS STEEL TRIANGLES** Not electro-polished

P/No	DIM 'A' NOMINAL	DIM 'B' NOMINAL	WIRE DIAMETER
17-70	45mm	31mm	6mm
17-73	50mm	44mm	6mm
17-75	50mm	44mm	6mm with 3mm bar
17-77	60mm	35mm	6mm
17-79	60mm	35mm	6mm with 3mm bar
17-81	50mm	50mm	8mm
17-83	67mm	39mm	8mm
17-85	80mm	46mm	8mm
17-87	80mm	46mm	8mm with 4mm bar
17-89	92mm	52mm	8mm
17-91	92mm	52mm	8mm with 4mm bar

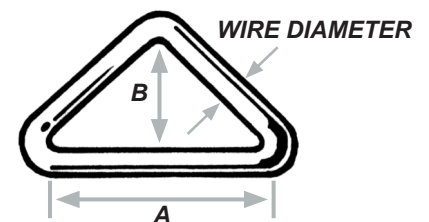



# HEADBOARDS

Anodised aluminium alloy headboards. Also available in other colours. Branding with your logo is also available on request.

P/No	DIM 'A'	DIM 'B'	DIM 'C'	DIM 'D'
06-45	88mm	114mm	19mm	1.5mm
06-46	114mm	144mm	19mm	1.5mm
06-48	114mm	144mm	19mm	3.0mm
06-50	133mm	165mm	19mm	3.0mm
06-52	159mm	209mm	25mm	3.0mm
06-54	153mm	153mm	19mm	1.5mm
06-56	133mm	165mm	24mm	3.0mm

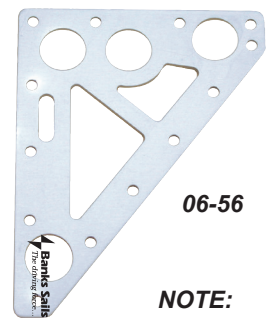
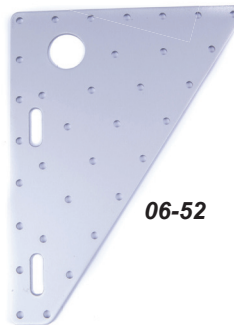
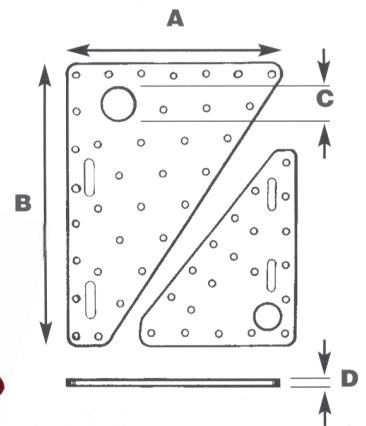

**NOTE:**  
06-54 not shown

# HEADBOARD LINER

P/No	DESCRIPTION
07-81	Stainless steel head board liner for 19mm diameter hole



# HANKS

## WHITE ACETAL HANKS

P/No	DIM 'A'	DIM 'B'	MAX WIRE SIZE
04-52	7mm	45mm	8mm
04-54	4.5mm	37mm	6mm



## BRONZE PISTON HANKS Roll-over fastening

P/No	MAX STAY SIZE	OVERALL LENGTH
05-70	6mm	43mm
05-72	10mm	53mm
05-74	13mm	64mm
05-76	16mm	80mm



# SHACKLES

White nylon shackle with 42mm internal height. Particularly useful with fully battened mainsails.

## SPECIAL LONG SHACKLE

P/No	DIM 'A'	DIM 'B'
04-58	8mm	60mm

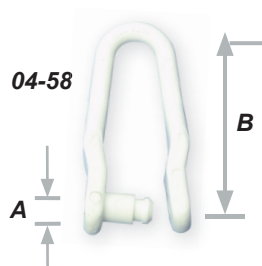

## WHITE NYLON SHACKLE

P/No	DIM 'A'	DIM 'B'
04-59	8mm	47mm
04-59St - with self tapping screw	8mm	47mm
04-61	6mm	37mm
04-61St - with self tapping screw	6mm	37mm



# SLIDERS

## FLAT BASE SLIDERS

P/No	DIM 'A'	DIM 'B'
04-62	19mm	24mm
04-63	19mm	22mm
04-65	19mm	18mm
04-67	19mm	16mm

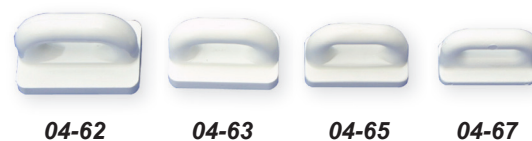
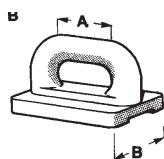

## SLUG SLIDERS

P/No	DIM 'A'	DIM 'B'	DIM 'C'
04-70	23mm	9mm	13.5mm
04-72	22mm	12mm	13.5mm

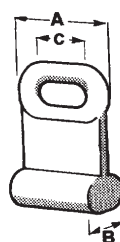

## S/K SLIDERS

P/No	DIM 'A'	DIM 'B'	DIM 'C'
04-75	30mm	14mm	15.5mm
04-77	25mm	10mm	14mm

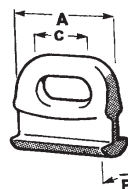

# HOOKS

## NYLON SHOCK CORD HOOKS

P/No	DESCRIPTION	MAX SHOCK CORD DIA
25-43	Small shock cord hook	5mm
25-44	Medium shock cord hook	8mm
25-45	Large shock cord hook	7.5mm



# SEW ON HOOKS & EYES

## SEW-ON HOOKS AND EYES

P/No	DESCRIPTION
07-65B	Sew-on hook, black
07-65W	Sew-on hook, white
07-66B	Sew-on eye, black
07-66W	Sew-on eye, white



07-65W

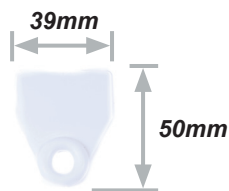

07-66W

# INGLEFIELD HOOKS

## INGLEFIELD HOOKS

These nylon hooks are ideal for securing covers and are prevented from disappearing into cord runs by the novel fish-tails.

P/No	DESCRIPTION
16-50	Black nylon Inglefield hook
16-52	White nylon Inglefield hook

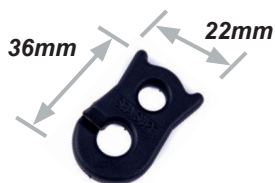

16-50



16-52

# LACING BUTTON

Lacing buttons – are ideal for holding boat covers in place. They are available in black and white and can be used either screwed down or on the end of shock cord.

P/No	DESCRIPTION
25-61B	for covers, black
25-61W	for covers, white
25-65B	for shock cord, black
25-65W	for shock cord, white



# TOGGLE BUTTONS

P/No	DESCRIPTION
25-62	Black nylon toggle button



# BLOCK RANGE

SeaSure manufacture an extensive range of blocks, all of which have been tested in the most extreme race conditions and proven over time. Once you have decided on the layout of your control lines these key elements will help you select the most suitable block:

- The type and size of rope or wire to be used.
- The sheave material – depending on the use of either rope or wire.
- The bearing type – depending on the operational loads being taken.
- The body construction – often determining the ultimate load carrying capacity and weight of the block.
- The ultimate breaking load.
- The block weight.



## 25mm BLOCKS

- A range of control line configuration opportunities.
- The high strength to weight ratio and simple construction gives years of trouble free service.
- They feature hollow rivets for lightness and tough plastic sheaves that provide a good bearing surface allowing easy rotation.
- Electro-polished 316 stainless steel construction.

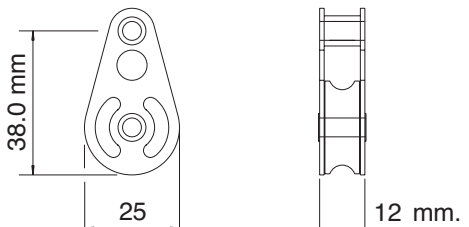
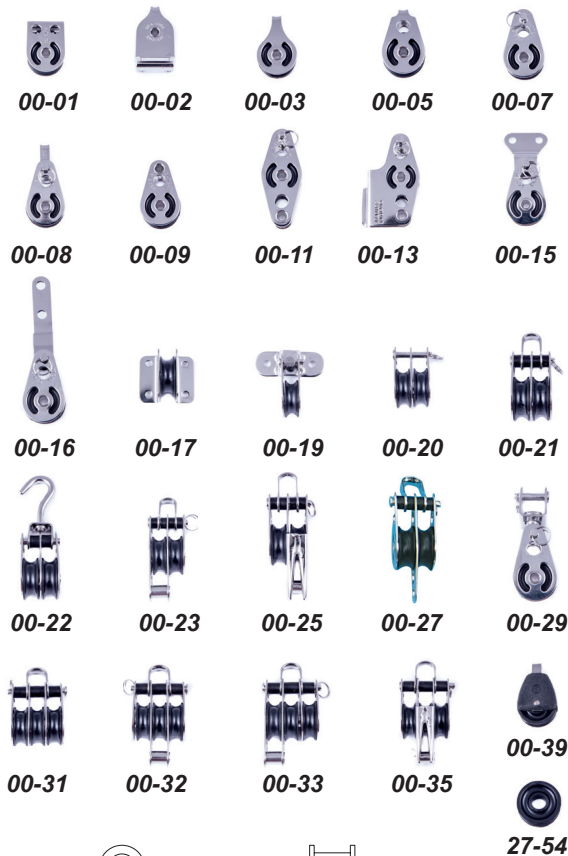

**Rope Sizes & Types:** Up to 8mm; standard 3 strand or plaited nylon, polyester and polypropylene ropes.

**Sheave:** Tough “Arnite” plastic

**Bearing:** Plain – low friction plastic onto s/steel.

**Body construction:** Electro-polished 316 s/s with hollow rivet.

**Weights:** 18g(00-07) to 49g (00-31)

**Typical uses:** Control lines, halyards, outhauls, kicking straps, furling lines, cunninghams traveller control lines, leech lines, dinghy spinnaker sheets, guys and halyards.

P/No	DESCRIPTION
00-01	Bolt down block
00-02	Deck mounted block
00-03	General purpose block
00-05	General purpose block (no-tumble action when used with lacing eye part no. 25-17)
00-07	Single block with clevis pin
00-08	Single block with shackle
00-09	Single block with hollow rivet
00-11	Single block with becket
00-13	Single block with V-jammer
00-15	Quarter lead block, short plate
00-16	Quarter lead block, long plate
00-17	Deck lead block
00-19	Base mounted swivel block
00-20	Double block with clevis pin
00-21	Double block with shackle
00-22	Double swivel hook block
00-23	Double block with becket
00-25	Double block with V-jammer
00-27	Double block with centre becket
00-29	Swivel block
00-31	Treble block with shackle
00-32	Treble block with centre becket
00-33	Treble block with becket
00-35	Treble block with V-jammer
00-39	General purpose block
27-54	Sheave only

# 19 & 28mm CARBON FIBRE CHEEKED BALL RACE BLOCKS

SeaSure have been producing some of the worlds most reliable control line blocks for more than 25 years. This latest development with carbon fibre cheeks make them super hard wearing if a miss-lead occurs.

- Light weight, high load carrying capacity blocks.
- Reliable race proven designs.
- High wear resistant cheek material extends life if miss-lead occurs.
- Freewheeling for fast line take up.

Rope Sizes & Types: 6mm & 8mm, Dyneema, Spectra or Kevlar; 3 strand or plaited nylon, polyester and polypropylene ropes.

Sheave: Self lubricating graphite loaded POM.

Bearing: Stainless steel balls with carbon fibre hub and cage.

Body construction: Carbon fibre with 316 stainless steel strap.

Weights: 13g (19-74); 118g (28-82).

Typical uses: Control lines, halyards, outhauls, kicking straps, furling lines, cunninghams, traveller control lines, leech lines spinnaker sheets, guys and halyards.



**19-74**  
**28.70**



**19-76**  
**28.72**



**19-78**  
**28.74**



**19-80**  
**28.76**



**19-82**  
**28.78**



**19-84**  
**28.80**



**19-86**  
**28.82**



**19-88**  
**28.84**



**19-89**  
**28.89**

P/No	DESCRIPTION	BREAKING LOAD
19-74	Single block	530kg
19-76	Single block with integral swivel	530kg
19-78	Single block with becket	530kg
19-80	Single bolt down block	530kg
19-82	Double block with shackle	1,000kg
19-84	Double block with shackle & becket	1,000kg
19-86	Treble block with shackle	1,300kg
19-88	Treble block with shackle & becket	1,300kg
28-70	Single block	650kg
28-72	Single block with integral swivel	650kg
28-74	Single block with becket	650kg
28-76	Single bolt down block	650kg
28-78	Double block with shackle	1,225kg
28-80	Double block with shackle and becket	1,225kg
28-82	Treble block with shackle	1,600kg
28-84	Treble block with shackle and becket	1,600kg
19-89	19mm Jammer	
28-89	28mm Jammer	

**19mm range**

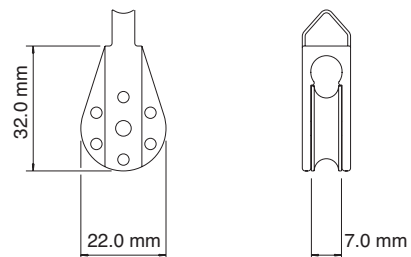

**28mm range**

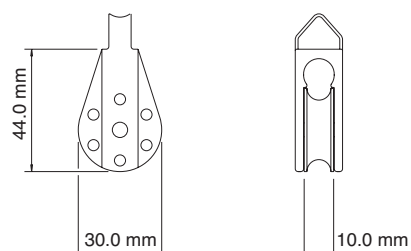

# FASTLEADS

FastLeads can be used for a variety of rope lead applications on both racing and cruising yachts.

With the increasing use of advanced aramid ropes, FastLeads have been developed with smooth surfaces to offer a high strength 'all direction' lead.

Developed initially for high performance racing yachts and proven in action on board TP52 yachts, FastLeads can be used as high load rope tidys around the deck. With large eyes they are ideal for securing a floating block when required.

With smooth surfaces in all directions FastLeads will not chafe control lines or halyards.

Produced from precision CNC machined aircraft grade aluminium and with a highly polished PTFE impregnated finish, there are no drill holes on the outer surface.

FastLeads are secured through the base with stainless machine screws for ultimate strength.

P/No	DESCRIPTION
31.00	Sheet Deflector 5mm
31.01	Sheet Deflector 8mm
31.02	Sheet Deflector 10mm
31.03	Sheet Deflector 12mm
31.04	Sheet Deflector 16mm
31.05	Oval Fairlead M4
31.06	Oval Fairlead M6
31.07	Oval Fairlead M8
31.08	Oval Fairlead M10
31.09	Oval Fairlead M12
31.10	Jib Sheet Fairlead M4
31.11	Jib Sheet Fairlead M6
31.12	Jib Sheet Fairlead M8
31.13	Jib Sheet Fairlead M10
31.14	Jib Sheet Fairlead M12



Part no.	Description	Length	Height	Width	Hole Distances	Hole dia	max rope diameter
31.00	Sheet Deflector M6	36	18	12	22.5	9	6mm
31.01	Sheet Deflector M8	48	24	16	30	12	10mm
31.02	Sheet Deflector M10	60	30	20	37.5	15	12mm
31.03	Sheet Deflector M12	72	36	24	45	18	16mm
31.04	Sheet Deflector M16	108	54	36	67.5	27	24mm
31.05	Oval Fairlead M4	34.4	20.8	15	25.6	12	10mm
31.06	Oval Fairlead M6	51.6	31.2	20	38.4	18	16mm
31.07	Oval Fairlead M8	68.8	41.6	30	51.2	24	20mm
31.08	Oval Fairlead M10	86	52	35	64	30	26mm
31.09	Oval Fairlead M12	103.2	62.4	40	76.8	36	32mm
31.10	Jib Sheet Fairlead M4	51.2	20.8	15	3 fixing holes	12	10mm
31.11	Jib Sheet Fairlead M6	76.8	31.2	20	3 fixing holes	18	16mm
31.12	Jib Sheet Fairlead M8	102.4	41.6	30	3 fixing holes	24	20mm
31.13	Jib Sheet Fairlead M10	102.4	52	35	3 fixing holes	30	26mm
31.14	Jib Sheet Fairlead M12	153.6	62.4	40	3 fixing holes	36	32mm

# CARBON FIBRE ROLLER RACE BLOCKS

These simple yet strong blocks are low weight and operate well under a wide range of load conditions. The use of carbon fibre needle roller bearings means that they run well even under high loads whilst freewheeling under light loads for fast line take-up.

Typical uses: Control lines, halyards, outhauls, kicking straps, furling lines, cunninghams, traveller control lines, leech lines, dinghy spinnaker sheets, guys and halyards.

The 09-60 and 29-60 are designed for "In-boom" reefing systems and feature soft rubber type bodies to prevent damage and reduce noise within the boom. Also available with black sheave.

## 09-XX RANGE (28MM DIAMETER SHEAVES)

Rope Sizes & Types: All types up to 8mm (10mm max)  
 Sheave: Acetal  
 Bearing: Densely packed carbon fibre needle rollers  
 Body construction: Acetal banded with 316 s/steel strap  
 Breaking Loads: 500kg (09-02)  
 Weight: 29g (09-02)



P/No	DESCRIPTION	WEIGHT
09-01	Single block with shackle	34g
09-02	Single block with clevis pin	29g
09-03	Single block with becket	42g
09-04	Quarter lead block, short base	39g
09-05	Quarter lead block, long base	38g
09-06	Single block with hanging swivel	49g
09-07	Base mounted swivel block	47g
09-10	Double block with shackle	54g
09-50	Single bolt down block	34g
09-60	Inside boom single line reefing block	75g

## 29-XX RANGE (42MM DIAMETER SHEAVES)

Rope Sizes & Types: All types up to 10mm (12mm max)  
 Sheave: Acetal  
 Bearing: Densely packed carbon fibre needle rollers  
 Body construction: Acetal banded with 316 stainless steel strap.  
 Breaking Loads: 1,300kg (29-01)  
 Weight: 67g (29-01)



P/No	DESCRIPTION	WEIGHT
29-01	Single block with clevis pin	67g
29-02	Single block with shackle	78g
29-03	Single block with becket	95g
29-05	Single block with hanging swivel	104g

P/No	DESCRIPTION	WEIGHT
29-06	Base mounted swivel block	100g
29-10	Double block with shackle	122g
29-30	Single bolt-down block	116g
29-60	Inside boom single line reefing block	138g

### 39-XX RANGE (50MM DIAMETER SHEAVES)

Rope Sizes & Types: All types up to 12mm (14mm max)  
 Sheave: Acetal  
 Bearing: Densely packed carbon fibre needle rollers  
 Body construction: Acetal banded with 316 s/steel strap  
 Breaking Loads: 1,600kg (39-02) ; (39-10)

*The 39-XX range is available with aluminium sheaves to suit wire rope.*

*To order, add suffix 'A' to the part number (eg: 39-02A)*

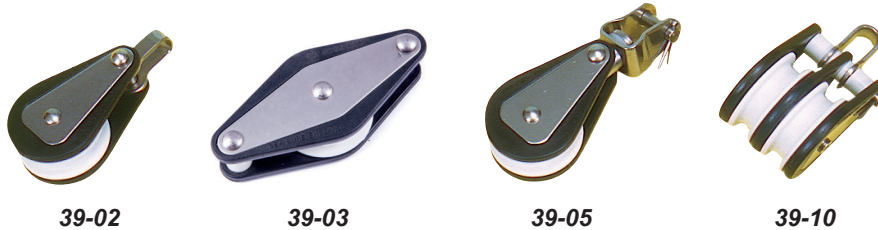

P/No	DESCRIPTION	WEIGHT	P/No	DESCRIPTION	WEIGHT
39-02	Single block with shackle	137g	39-05	Single block with hanging swivel	180g
39-03	Single block with becket	157g	39-10	Double block with shackle	220g

### 25mm STAINLESS SHEAVE BLOCKS – BALL RACE

These ball race blocks are designed to take high loads and be very light. They have a double row of captive stainless steel balls running within a stainless steel sheave. This ensures minimal deflection of both ball and housing helping prevent "dig in" under high loads.

Rope Size/Types: 4mm wire, Dyneema, Spectra or Kevlar  
 Sheave: 316 stainless steel  
 Bearing: Double row stainless steel ball  
 Body construction: Electro polished 316 s/s with hollow rivet  
 Breaking Loads: 950kg (01-32)  
 Weights: 32g (01-32)  
 Typical uses: Control lines, halyards, outhauls, kicking straps, furling lines, cunninghams, traveller control lines, leech lines.



P/No	DESCRIPTION
01-30	Single block with shackle
01-32	Single block with clevis pin
01-34	Single block with becket
01-36	Single block with hollow rivet
01-38	General purpose block
01-40	Single bolt down block

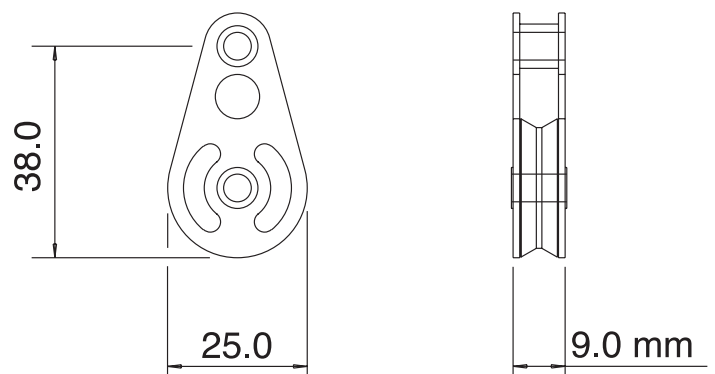



# BRASS SHEAVE BLOCKS

For use in high load applications such as those imposed by wire and Dyneema halyards. The stainless steel side plates prevent highly abrasive ropes from cutting in.

Rope Sizes & Types: 4mm wire, Dyneema, Spectra or Kevlar  
 Sheave: Chrome plated brass  
 Bearing: Plain – chrome plated brass onto s/steel  
 Body construction: Electro polished 316 s/s with hollow rivet  
 Breaking Loads: 950kg (01-02)  
 Weight: 35g (01-02)  
 Typical uses: Halyards, outhauls, kicking straps, cunninghams, traveller control lines, leech lines.

P/No	DESCRIPTION
01-01	Single block with shackle
01-02	Single block with clevis pin
01-03	Single block with becket
01-04	Single block with hollow rivet
01-06	Spar mounted block (Curved lugs)
01-08	Spar mounted block (Flat lugs)
01-09	Wire guide block (Aluminium sheave)
01-10	In line fixing mast sheave (Small side plates)
01-12	In line fixing mast sheave
01-14	Deck lead block
01-16	General purpose block
01-18	Single bolt down block

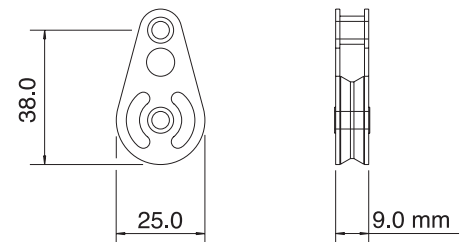
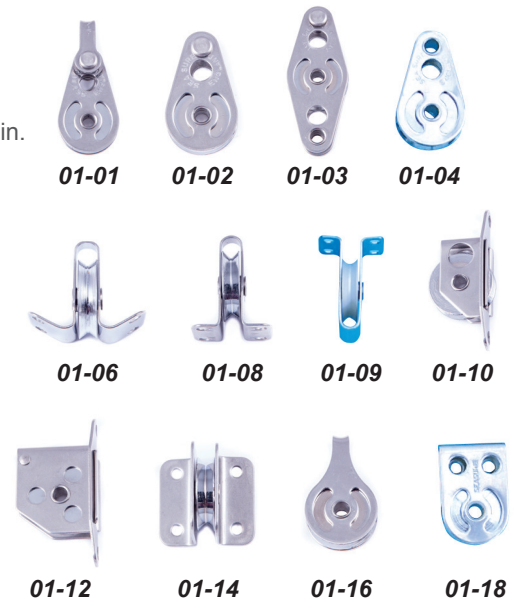

# ALLOY SHEAVE BLOCKS

These blocks have aluminium sheaves and are for use with wire and aramid type ropes when very high loads are involved. They feature a plain bearing on carbon fibre bush for trouble free use under load.

Rope Sizes & Types: 6mm & 8mm, wire, Dyneema, Spectra or Kevlar  
 Sheave: Aluminium  
 Bearing: Plain – carbon fibre bush on 316 s/s pin  
 Body construction: 316 stainless steel  
 Breaking Loads: 1,600kg (04-00); 2,400kg (04-04); 850kg (04-05)  
 Weights: 76g (04-00); 79g(04-04); 61g (04-05)  
 Typical uses: Halyards, outhauls, kicking straps, cunninghams, traveller control lines, leech lines

P/No	DESCRIPTION
04-00	Single block with clevis pin
04-04	Bolt down block 17mm wide
04-05	Bolt down block 10mm wide
05-21	Sheave only (Supplied with bush)

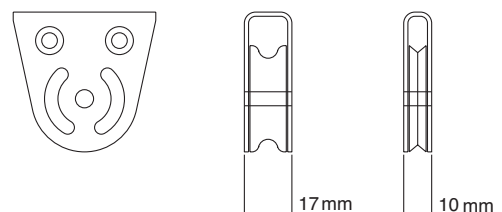
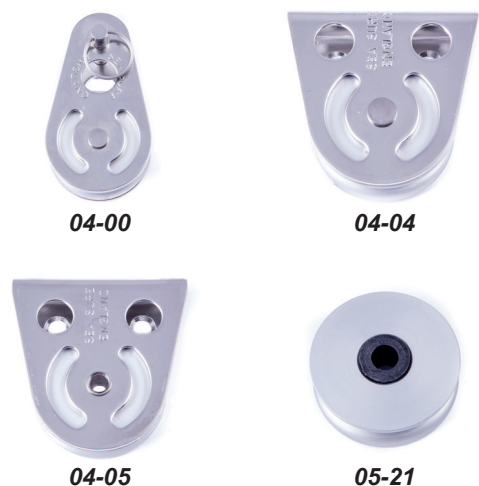

# BLOCKS

## 38MM BLOCKS

These are tough general purpose high load blocks. They have a similar classic design to the 25mm range but have very high load carrying capacity. Their simple construction and plain bearings means they are long lasting and require very little maintenance.

Rope Sizes & Types: Up to 10mm; standard 3 strand or plaited nylon, polyester and polypropylene ropes.  
 Sheave: Tough "Arnite" plastic  
 Bearing: Plain – low friction plastic onto stainless steel  
 Body construction: Electro-polished stainless steel  
 Breaking Loads: 1,400kg (03-01)  
 Weights: 64g (03-01)  
 Typical uses: Control lines, halyards, outhauls, kicking straps, furling lines, cunninghams, traveller control lines, leech lines, spinnaker sheets, guys and halyards

P/No	DESCRIPTION
03-00	Single block with shackle
03-01	Single block with clevis pin
03-03	Single block with becket
03-05	Bolt down block
03-06	Single block with V-jammer
03-31	Single block with hollow rivet
05-19	Sheave only

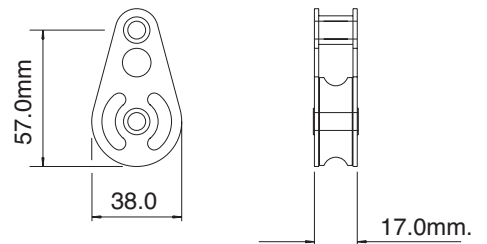

## 19MM CARBON FIBRE SHEAVES

A tough micro block designed for abrasive ropes and high loads. Because of its plain bearing design it will operate well under a wide range of load conditions.

Rope Sizes & Types: 4mm wire, Dyneema, Spectra or Kevlar  
 Sheave: Carbon Fibre  
 Bearing: Plain – Carbon Fibre onto stainless steel  
 Body construction: Electro polished 316 s/s with hollow rivet  
 Breaking Loads: 400kg (02-05) to 600kg (02-10)  
 Weights: 10g(02-05) to 18g (02-10)  
 Typical uses: Control lines, halyards, outhauls, kicking straps, furling lines, cunninghams, leech lines

P/No	DESCRIPTION
02-01	General purpose block
02-02	Base-mounted block
02-05	Single block with hollow rivets
02-06	Single block with clevis pin
02-07	Single block with shackle
02-09	Single sheaved cage block
02-10	Double block
02-11	Double block with becket
02-13	Double sheaved cage block
02-21	Single swivel block

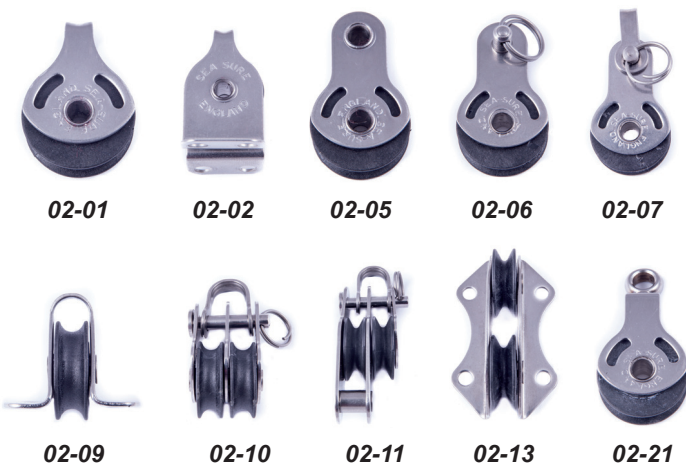
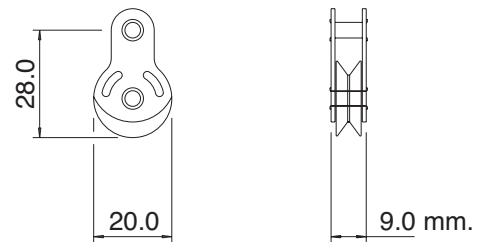

# BLOCKS

## 16MM MINI BLOCKS

Rope Sizes & Types: Up to 5mm – POM sheave - all ropes  
Stainless steel - wire ropes

Sheave: POM (02-14), stainless steel (02-15)

Bearing: Plain onto stainless steel pin

Body construction: 316 stainless steel

Breaking Loads: 175kg(00-40); 175kg(00-41)

Weights: 7g (02-14); 10g (02-15)

Typical uses: Lead blocks for a wide range

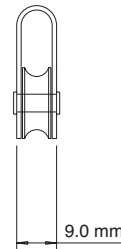
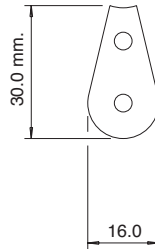

**02-15**

P/No	DESCRIPTION
02-14	Mini block with 16mm dia. plastic sheave
02-15	Mini block with 16mm dia. s/steel sheave

# SHUTTLE BLOCKS

These Phil Morrison designed line mounted shuttle blocks have a wide range of control line applications. The carbon fibre sheave is particularly hard wearing and suitable for modern aramid type ropes. Their soft moulded shape is designed to be snag free and protect against damage around the cockpit.

Rope Sizes & Types: 4mm (00-40) & 6 mm (00-41) Dyneema, nylon, polyester & polypropylene

Sheave: Carbon fibre

Bearing: Plain – carbon fibre onto stainless steel pin

Body construction: Nylon

Typical uses: Lead blocks for a wide range of control line applications

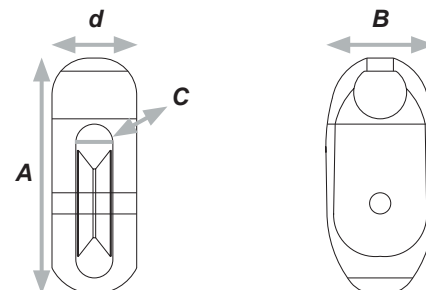

P/No	DIM 'A'	DIM 'B'	DIM 'C'	DIM 'D'	WEIGHT	BREAKING LOAD
00-40	42mm	20mm	7mm	15mm	9g	175kg
00-41	54mm	25mm	7mm	16mm	15g	175kg

**seasure**  
IDEAL FOR ALL  
LAZY JACK  
APPLICATIONS

# BLOCK ACCESSORIES, ADAPTORS & SWIVELS

## DECK, MAST AND STANCHION BLOCKS

These 316 stainless steel bodied turning blocks offer a range of stanchion mounting configurations. They are particularly useful for running furling headsail lines back to the cockpit. They are low maintenance and will continue to look good for years to come.

The hinged action allows the nylon sheave to pull into line as rope leaves the furling drum.

The rail mounted stanchion base (03-40) is designed so that no holes have to be drilled in the deck, significantly reducing the number of possible leakage points in the boat. Manufactured from 316 stainless steel and electro-polished to a high finish for better resistance.

To fit stanchion diameter 25mm (1").  
Suitable for up to 10mm diameter rope.

P/No	DESCRIPTION
03-40	Stanchion base (Toe rail mounting)
03-45	Replacement sheave for 03-48/50/51/52/53 25mm dia. sheave
03-48	Deck or mast mounted block with removable sheave
03-50	Stanchion mounted block used with furling rope
03-51	Similar to 03-50, but used on sharply angled stanchions
03-52	Toe rail mounted block. Similar to 03-50, but with flat base
03-53	Deck mounted block with 2 position sheave
03-55	Heavy duty mast block with removable plastic sheave 38mm dia. sheave
03-55A	As 03-55 with removable aluminium sheave
03-65	Stanchion mounted fairlead.



03-40



03-48



03-50



03-51



03-52

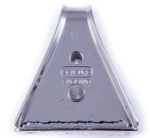

03-53



03-55



03-65

## ADAPTOR SHACKLES AND SWIVELS

Designed to fit the SeaSure 25mm and 38mm blocks ranges. They are manufactured from 316 stainless steel with low friction bearing washers for ease of movement under load.

P/No	DESCRIPTION
05-05	Swivel for use with blocks in the 25mm range
05-07	Base mounted swivel for use with blocks in the 25mm range
05-09	Hanging swivel for use with single and treble blocks in the 38mm range



05-05



05-09



05-07

# CLEATS FAIRLEADS & ROLLERS

## BLACK NYLON CLEATS

Very light and very strong. Moulded in top quality marine grade nylon so they will not corrode. They have a rounded sturdy appearance and are light in weight and strong.

P/No	DIM 'A'	DIM 'B'	DIM 'C'	WEIGHT
19-00	75mm	3.9mm	26.5mm	7g
19-02	100mm	3.9mm	28.5mm	13g
19-04	130mm	4.7mm	36.5mm	28g
19-06	165mm	5.5mm	42.8mm	48g
19-08	205mm	6.5mm </td <td>49.2mm</td> <td>82g</td>	49.2mm	82g
19-09	240mm	8.0mm	76.0mm	157g

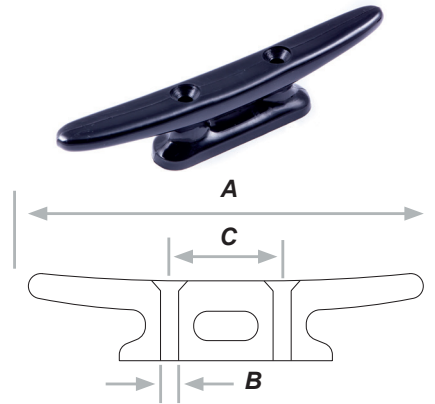

## CONTROL LINE CLEATS

These small cleats are excellent for a wide range of control line cleating applications. They are suitable for all types of line up to 6mm. Their aluminium spindle-grip means they are very hard wearing and have minimal run-back after cleating. They are also very light weight at only 20g each.

P/No	DESCRIPTION
19-10	Right hand cleat with hoop
19-11	Left hand cleat with hoop
19-13	Right hand cleat without hoop
19-14	Left hand cleat without hoop
19-16	Tapered packing piece for use with above cleats



19-10



19-11



19-13



19-14

## FAIRLEADS

P/No	DESCRIPTION	DIM 'A'	DIM 'B'	DIM 'C'
25-30	Black nylon fairlead	9.6mm	22mm	3mm
25-32	Black nylon fairlead	12mm	28mm	4mm
25-34	Black nylon fairlead	15mm	34mm	6mm
25-66	Black nylon fairlead with steel liner	7mm	22mm	3mm
25-67	Black nylon fairlead with steel liner	11mm	28mm	4mm
25-68	Black nylon fairlead with steel liner	14mm	34mm	6mm

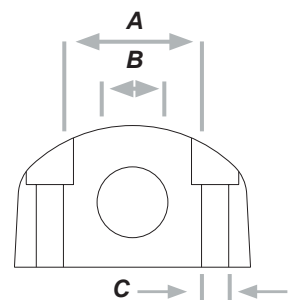

## BUTTON / ROLLER / SPACER

Ideal for fitting to shrouds and guard-rail wires to protect sails.

P/No	DIAMETER	THICKNESS	HOLE SIZE
20-97	50mm	12mm	6mm
20-99	70mm	16mm	12mm

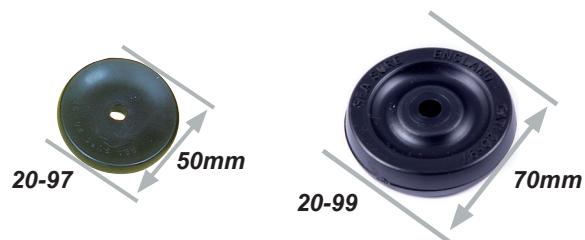

## SADDLE WASHERS

Useful in any situation requiring mounting flat fittings to curved surfaces.

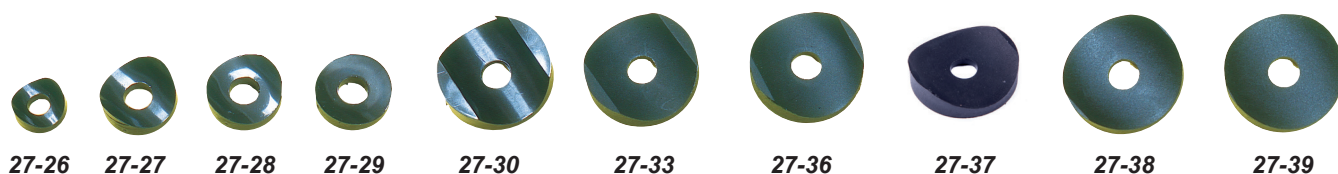

P/No	SUIT TUBE DIA	WASHER DIA	HOLE DIA
27-26	19mm (0.75")	16mm	6mm
27-27	25mm (1")	22mm	8mm
27-28	32mm (1.25")	22mm	8mm
27-29	76mm (3")	22mm	8mm
27-30	32mm (1.25")	32mm	8mm

P/No	SUIT TUBE DIA	WASHER DIA	HOLE DIA
27-33	38mm (1.5")	32mm	8mm
27-36	44mm (1.75")	32mm	8mm
27-37	51mm (2")	32mm	8mm
27-38	54mm (2.125")	32mm	8mm
27-39	57mm (2.25")	32mm	8mm

## BELAYING HOOK/ROPE TIDY

The belaying hook provides convenient stowage for halyards and hanks of line. Moulded in polypropylene, the hook is available in black, red, green and white and is supplied with a metre of line and a self-tapping screw.

P/No	DESCRIPTION
25-29BLK	Black belaying hook
25-29RED	Red belaying hook
25-29GRN	Green belaying hook
25-29WHI	White belaying hook



# SPINNAKER EQUIPMENT

## SPINNAKER POLE STORAGE BRACKETS

We manufacture a wide range of stowage brackets. All are manufactured from electro polished 316 stainless steel for a long, corrosion-free life. The flexible bracket can be used in places where crew may stand on them or where reduction in noise inside the boat is required.

P/No	DESCRIPTION	I/D OF RING
15-71	Stanchion mounted bracket (For 25mm dia. stanchion)	
15-72	Stowage bracket with ring	65mm
15-72S	As 15-72 with lower positioned ring	65mm
15-88	Packing piece for 15-86	



P/No	DESCRIPTION	HEIGHT OF BAR
15-73	Stowage bracket with bar	110mm
15-73S	Stowage bracket with bar	86mm
15-75	Stowage bracket with bar	84mm
15-77	Stowage bracket with bar	60mm
15-86	Flexible stowage bracket	45mm

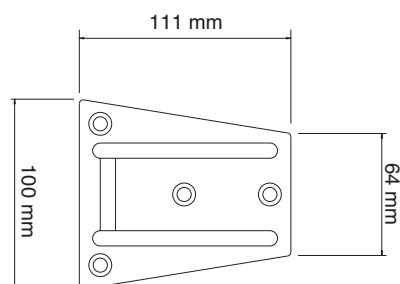
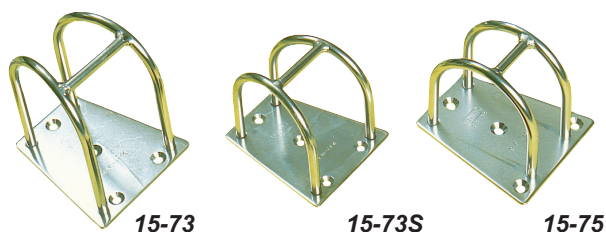

## SPINNAKER POLE FITTINGS

P/No	DESCRIPTION	WEIGHT
15-28	Spinnaker pole end to fit 40mm o/d tube	218g
15-30	Spinnaker pole end to fit 50mm o/d tube	321g
16-60	Up-haul / down-haul band for 51mm diameter pole	70g



# DROP NOSE PINS

Manufactured from 316 stainless steel and barrel finished for a smooth, high shine surface finish. We produce a wide range of pins from 20mm to 120mm long and between 6mm and 12mm diameter.

They have a spring loaded mechanism that positively locks the pin in either the open or closed position. The head features an annular groove for attachment of a retaining wire if required for larger bespoke pins and retaining wires. Call for quotation!

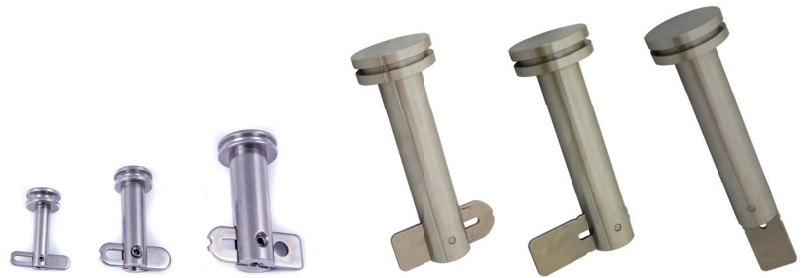

Working Length	5mm Diameter		6mm Diameter		8mm Diameter		10mm Diameter		12mm Diameter	
	SeaSure No	NATO No.	SeaSure No	NATO No.	SeaSure No	NATO No.	SeaSure No	NATO No.	SeaSure No	NATO No.
15mm	36-05-15	0265-99-395-8055								
20mm	36-05-20	0265-99-687-1714	36-06-20	0265-99-705-6148	36-08-20	0265-99-876-0183	36-10-20	0265-99-194-4770	36-12-20	0265-99-661-5578
23mm									36-12-23	0265-99-615-2791
25mm	36-05-25	0265-99-593-1798	36-06-25	0265-99-126-9370	36-08-25	0265-99-676-4107	36-10-25	0265-99-759-2046	36-12-25	0265-99-174-5528
30mm	36-05-30	0265-99-603-5662	30-06-30	0265-99-258-0081	36-08-30	0265-99-399-0827	36-10-30	0265-99-350-6055	36-12-30	0265-99-661-5731
35mm							36-10-35	0265-99-169-0041	36-12-35	0265-99-937-6576
40mm	36-05-40	0265-99-764-4380	36-06-40	0265-99-943-1157	36-08-40	0265-99-606-2947	36-10-40	0265-99-760-4926	36-12-40	0265-99-668-7716
45mm	36-05-45	0265-99-661-2311								
50mm	36-05-50	0265-99-732-7422	36-06-50	0265-99-519-0558	36-08-50	0265-99-136-3945	36-10-50	0265-99-476-5296	36-12-50	0265-99-136-6469
60mm			36-06-60	0265-99-239-2124	36-08-60	0265-99-448-0407	36-10-60	0265-99-297-5957	36-12-60	0265-99-851-4532
70mm			36-06-70	0265-99-750-9032	36-08-70	0265-99-126-9374	36-10-70	0265-99-514-9322	36-12-70	0265-99-547-7442
80mm			36-06-80	0265-99-308-1060	36-08-80	0265-99-132-1715	36-10-80	0265-99-983-0745	36-12-80	0265-99-767-6259
90mm			36-06-90	0265-99-875-2947	36-08-90	0265-99-601-7771	36-10-90	0265-99-212-2228	36-12-90	0265-99-742-0190
100mm			36-06-100	0265-99-480-7571	36-08-100	0265-99-228-3679	36-10-100	0265-99-270-7572	36-12-100	0265-99-392-5271
110mm			36-06-110	0265-99-326-6011	36-08-110	0265-99-902-0576	36-10-110	0265-99-737-2226	36-12-110	0265-99-488-6315
120mm			36-06-120	0265-99-290-5815	36-08-120	0265-99-957-4357	36-10-120	0265-99-212-2229	32-12-120	0265-99-346-4142

# BIG HEAD DESIGN

The new big head design allows for easier lanyard attachment. It enables you to splice, tie or wire crimp an attachment so that the drop nose pin can be securely fastened.

Working Length	5mm Diameter	6mm Diameter	8mm Diameter	10mm Diameter	12mm Diameter
SeaSure No.	SeaSure No.	SeaSure No.	SeaSure No.	SeaSure No.	SeaSure No.
15mm	36-05-15BH				
20mm	36-05-20BH	36-06-20BH	36-08-20BH	36-10-20BH	36-12-20BH
23mm					36-12-23BH
25mm	36-05-25BH	36-06-25BH	36-08-25BH	36-10-25BH	36-12-25BH
30mm	36-05-30BH	30-06-30BH	36-08-30BH	36-10-30BH	36-12-30BH
35mm				36-10-35BH	36-12-35BH
40mm	36-05-40BH	36-06-40BH	36-08-40BH	36-10-40BH	36-12-40BH
45mm	36-05-45BH				
50mm	36-05-50BH	36-06-50BH	36-08-50BH	36-10-50BH	36-12-50BH
60mm		36-06-60BH	36-08-60BH	36-10-60BH	36-12-60BH
70mm		36-06-70BH	36-08-70BH	36-10-70BH	36-12-70BH
80mm		36-06-80BH	36-08-80BH	36-10-80BH	36-12-80BH
90mm		36-06-90BH	36-08-90BH	36-10-90BH	36-12-90BH
100mm		36-06-100BH	36-08-100BH	36-10-100BH	36-12-100BH
110mm		36-06-110BH	36-08-110BH	36-10-110BH	36-12-110BH
120mm		36-06-120BH	36-08-120BH	36-10-120BH	32-12-120BH





## CLEVIS PINS

### PIN DIAMETER = 4.75MM (3/16")

P/No	LENGTH	P/No	LENGTH
34-00	10mm	34-05	17mm
34-01	13mm	34-06	19mm
34-02	11mm	34-07	25.4mm
34-03	16mm	34-09	35mm

### PIN DIAMETER = 7.9MM (5/16")

P/No	LENGTH	P/No	LENGTH
34-23	19mm	34-29	38mm
34-25	25.4mm	34-35	57mm
34-27	32mm		

### PIN DIAMETER = 9.5MM (3/8")

P/No	LENGTH	P/No	LENGTH
34-44	19mm	34-48	32mm
34-45	22mm	34-50	38mm
34-46	25.4mm		

### PIN DIAMETER = 6.35MM (1/4")

P/No	LENGTH	P/No	LENGTH
34-11	18.5mm	34-16	35mm
34-13	22mm	34-17	44.5mm
34-14	25.4mm	34-18	49mm

### PIN DIA = 11MM (7/16")

P/No	LENGTH
34-57	25.4mm
34-59	31.8mm

### PIN DIA = 12.7MM (1/2")

P/No	LENGTH
34-68	25.4mm
34-70	31.8mm

### PIN DIA = 15.9MM (5/8")

P/No	LENGTH
34-81	31mm



## SPLIT RINGS

### SPLIT RINGS

P/No	LENGTH
35-00	10.0mm
35-02	16.2mm
35-04	21.4mm
35-05	28.0mm



## BUDGET CHAIN HOOK

### CHAIN HOOK STAINLESS STEEL

P/No	To suit Chain Dia.
40.00	6mm (1/4")
40.01	8mm (5/16")
40.02	10mm (3/8")
40.03	12mm (1/2")



## WASHERS

P/No	DIM 'A'	DIM 'B'	MATERIAL THICKNESS
25-84	5mm	32mm	2mm
25-85	6.7mm	32mm	2mm
25-86	8mm	32mm	2mm
25-87	10mm	32mm	2mm
25-88	13mm	32mm	2mm
25-89	11.5mm	32mm	2mm
26-01	4mm	25mm	2mm
26-03	5mm	25mm	2mm
26-05	6mm	25mm	2mm
26-07	7mm	25mm	2mm
26-09	8mm	25mm	2mm
26-31	13mm	38mm	2mm
26-33	16mm	38mm	2mm
26-35	19mm	38mm	2mm

## SWIVEL ANCHOR CONNECTOR

P/No	DESCRIPTION
08-23	8-12mm Swivel anchor connector

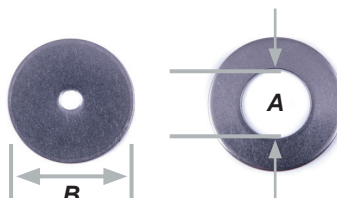

# TANGS

P/No	OVERALL LENGTH	WIDTH	HOLE DIAMETER	MATERIAL	WEIGHT
27-00	51mm	19mm	8mm & 10mm	12swg	15g
27-01	Angled 30o	19mm	8mm & 10mm	12swg	15g



# DECK EYES

Our range of deck eyes, clips and hooks are manufactured from top grade AISI 316 stainless steel. They undergo multiple machining and finishing operations to ensure they have a smooth finish and are free of damaging sharp corners and burrs.

P/No	DIM 'A'	DIM 'B'	DIM 'C'
25-09	8.5mm	24mm	3.5mm
05-31	10mm	31mm	4.5mm
05-36	17mm	45mm	4.5mm
25-10	13mm	25mm	4.5mm
25-17	5mm	24mm	4.5mm
25-24	27mm	30mm	4.5mm
05-23	9mm	28mm	3.5mm
05-24	14mm	42mm	5.0mm
05-25	22mm	55mm	6.5mm

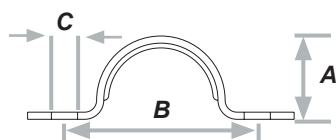
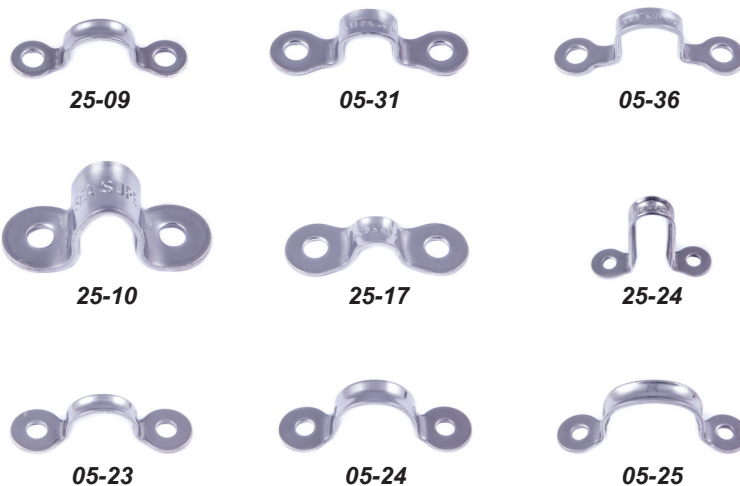

## BUDGET WIRE EYE STRAP S/STEEL

P/No	Material Diameter
40.37	4mm
40.38	6mm
40.39	8mm



## BUDGET EYE STRAP S/STEEL

P/No	Dim A	Height
40.35	30mm	8mm
40.36	33mm	11mm

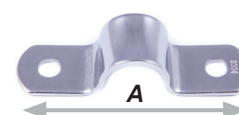

## BUDGET TWO HOLE PAD EYE STAINLESS STEEL

P/No	Dim A	Dim B	Wire Dia
40.29	35mm	15mm	5mm
40.30	46mm	20mm	6mm

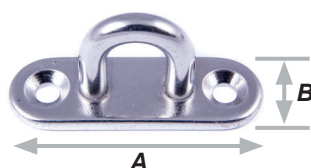

## BUDGET TWO HOLE ROUND EYE PLATE STAINLESS STEEL

P/No	Dim A	Dim B
40.34	38mm	19mm

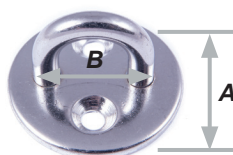

## BUDGET SQUARE EYE PLATE STAINLESS STEEL

P/No	Dim A	Dim B
40.31	30mm	35mm
40.32	35mm	40mm
40.33	40mm	50mm



# STANCHION MOUNTING EYES

P/No	DESCRIPTION
25-05	Clip for 25mm (1") stanchion
25-04	Backing plate for 25-05
25-07	Clip for 32mm (1.25") stanchion
25-08	Backing plate for 25-07
25-06	Panel clip for 25mm (1") diameter tube

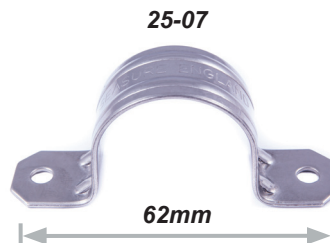
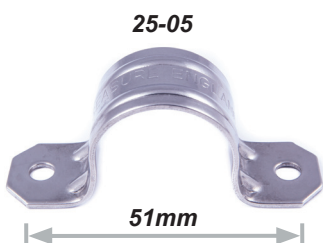
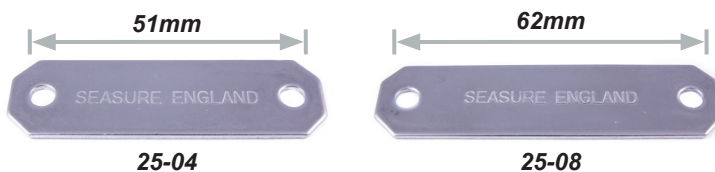

# EYE PLATES

Our range of deck eyes, clips and hooks are manufactured from top grade AISI 316 stainless steel. They undergo multiple machining and finishing operations to ensure they have a smooth finish and are free of damaging sharp corners and burrs.

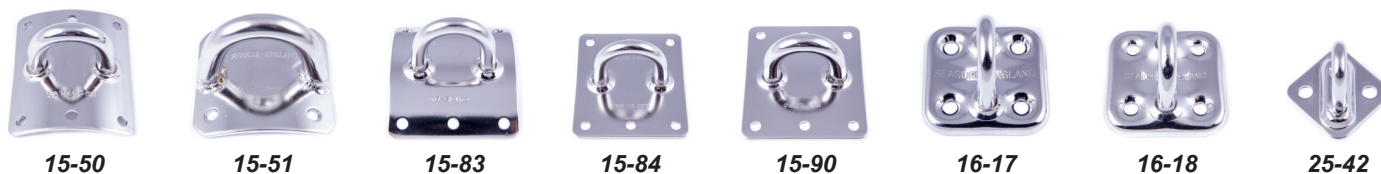

P/No	DESCRIPTION	PLATE SIZE (mm)	PLATE THICKNESS (mm)	EYE MATERIAL DIA. (mm)	FIXING HOLE DIA. (mm)
15-50	Bow mast plate - 75mm radius	73 x 65	2.0	9.5	5.0
15-51	Bow mast plate - 75mm radius	70 x 76	3.0	12.7	6.8
15-82	Cruiser mast plate - horizontal eye	64 x 73	2.0	8.0	5.0
15-83	Cruiser mast plate - vertical eye	64 x 76	2.0	8.0	5.0
15-84	Flat eye plate	64 x 73	2.0	8.0	5.0
15-84B	Nest plate for 15-84				
15-90	Flat eye plate	64 x 73	2.0	9.5	5.0
15-90B	Nest plate for 15-90				
15-91	Flat eye plate	76 x 70	3.0	12.7	6.8
15-91B	Nest plate for 15-91				
16-17	Pad eye - compliments 23-XX range	46 x 46	1.5	6.3	
16-18	Pad eye - compliments 23-XX range	55 x 55	2.0	8.0	
25-42	Small mast or deck eye	28 x 28	1.5	5.5	5.0

# GUNWALE EYES

P/No	DIM 'A'	DIM 'B'
05-32	30mm	25mm
05-37	39mm	40mm

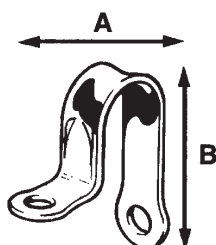

## SPAR CLIPS AND EYES

P/No	DESCRIPTION	DIM 'A'
25-12	Eye with curved base to fit 25mm or 32mm diameter poles	27mm
25-39	Twisted mast eye	43mm



25-12



25-39

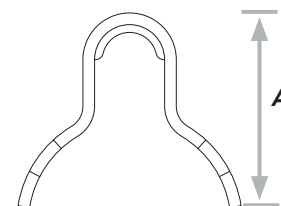

## HOOKS

P/No	DESCRIPTION	HOLE PITCH	HOLE DIAMETER
25-15	Flat reefing hook	12.7mm	4mm
27-60	Curved reefing hook, to suit 50mm or 62mm tube	12.7mm	4mm
25-16	Small lacing hook	15.7mm	4mm
25-18	Long lacing hook	12.7mm	4mm
25-19	Heavy duty short lacing hook (14swg)	12.7mm	4mm
25-26	Halyard lock for dinghies with external halyards	12.7mm	5mm



25-15



25-16



25-18



25-19



25-26

## 'S' HOOKS

P/No	DESCRIPTION	OVERALL LENGTH
25-27	'S' hook, 6.3mm dia. material	78mm
25-28	'S' hook, 8mm dia. material	67mm



25-27



25-28

## FORGED CARBINE HOOKS



Manufactured in Europe by Kong for guaranteed material quality. This wide range of hooks has a size and style to suit virtually any application and have certified load carrying capacity.



**seasure**  
FORGED & TESTED  
FOR SAFETY

P/No (Plain)	P/No (With eye)	OVERALL LENGTH	MATERIAL DIAMETER	BREAKING LOAD
08-50	08-60	50mm	5mm	450KG
08-51	08-61	60mm	6mm	500KG
08-515	08-615	70mm	7mm	600KG
08-52	08-62	80mm	8mm	800KG



08-51

P/No (Plain)	P/No (With eye)	OVERALL LENGTH	MATERIAL DIAMETER	BREAKING LOAD
08-53	08-63	100mm	10mm	1200kg
08-54	08-64	120mm	11mm	2000kg
08-55	08-65	160mm	13mm	4000kg



08-54



06-85

## FORGED ASYMMETRIC CARBINE HOOKS

P/No (Plain)	P/No (With eye)	OVERALL LENGTH	MATERIAL DIA.	BREAKING LOAD
08-89	08-90	52mm	5mm	150kg
08-91	08-92	65mm	6mm	150kg
08-93	08-94	87mm	8mm	800kg
08-95	08-96	103mm	10mm	1200kg
08-97	08-98	125mm	12mm	2000kg



## CARBINE HOOK – OTHER TYPES

P/No	DESCRIPTION	OVERALL LENGTH	MATERIAL DIA	BREAKING LOAD
08-70	Carbine hook with screw down safety collar	100mm	10mm	1200kg
08-71	Carbine hook with screw down safety collar	120mm	12mm	2000kg
08-82	Eccentric plain	100mm	10mm	1200kg
08-84	Eccentric with wire eye	100mm	10mm	1200kg
08-79	Outward opening arm	100mm	10mm	1200kg
08-85	Sliding sleeve hook with wire eye	80mm	8mm	800kg
08-83	Sliding sleeve hook with wire eye	100mm	10mm	1200kg
08-47	Offset spring clip	80mm	8mm	800kg
08-48	Offset spring clip	100mm	10mm	1200kg
08-49	Offset spring clip	120mm	12mm	2000kg



08-70



08-71



08-79



08-82



08-85/08-83



08-47/08-48/08-49

## BUDGET CARBINE HOOKS

### CARBINE HOOK STAINLESS STEEL

P/No	Overall length
41.13	50mm with eye
41.14	60mm with eye
41.15	70mm with eye
41.16	80mm No eye
41.17	100mm with eye
41.18	120mm No eye



# FORGED D-SHACKLES

All shackles are forged in Europe from AINI 316 stainless steel for superior strength.

**seasure**

FORGED & TESTED  
FOR SAFETY

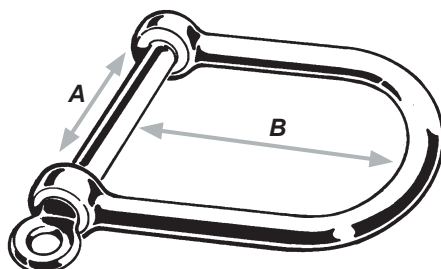

## STRAIGHT SHACKLES

P/No	MATERIAL DIA.	DIM 'A'	DIM 'B'	BREAKING LOAD	WEIGHT
14-00	4mm	8mm	15mm	1000kg	7g
14-01	5mm	10mm	17mm	1500kg	13g
14-02	6mm	12mm	19mm	1800kg	23g
14-03	8mm	16mm	30mm	4300kg	61g
14-04	10mm	20mm	33mm	5700kg	112g
14-05	12mm	24mm	40mm	8000kg	240g



## STRAIGHT SHACKLES WITH ALLEN SCREW

P/No	MATERIAL DIA.	DIM 'A'	DIM 'B'	BREAKING LOAD	WEIGHT
14-52	6mm	12mm	19mm	2300kg	22g



## LONG FORGED D-SHACKLES

P/No	MATERIAL DIA.	DIM 'A'	DIM 'B'	BREAKING LOAD	WEIGHT
14-15	4mm	8mm	26mm	1100kg	9g
14-16	5mm	11mm	39mm	1300kg	20g
14-17	6mm	12mm	47mm	2000kg	35g
14-18	8mm	16mm	58mm	3700kg	82g



## LARGE FORGED D-SHACKLES

P/No	MATERIAL DIA.	DIM 'A'	DIM 'B'	BREAKING LOAD	WEIGHT
14-44	5mm	22mm	36mm	1000kg	21g
14-45	6mm	28mm	42mm	1400kg	38g
14-46	8mm	34mm	53mm	3500kg	88g
14-47	10mm	43mm	70mm	5200kg	180g



## HALYARD KEY SHACKLES

P/No	MATERIAL DIA.	DIM 'A'	DIM 'B'	BREAKING LOAD	WEIGHT
14-67	5mm	14mm	15mm	900kg	30g
14-68	6mm	16mm	18mm	1300kg	47g
14-69	8mm	21mm	25mm	2500kg	119g

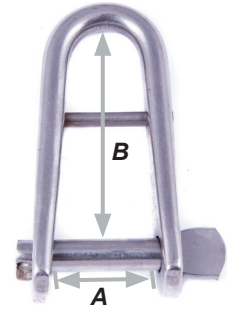

## KEY PIN SHACKLES

P/No	MATERIAL DIA.	DIM 'A'	DIM 'B'	BREAKING LOAD	WEIGHT
14-60	5mm	14mm	36mm	1100kg	30g
14-61	6mm	16mm	43mm	1400kg	46g
14-62	8mm	21mm	59mm	2600kg	116g

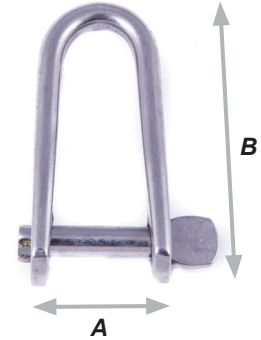

## NAVAL BRONZE BOAT SNAPS

P/No	SIZE	OVERALL LENGTH	EYE I/D
10-50	0	55mm	11mm
10-51	1	73mm	16mm
10-52	2	82mm	18mm
10-53	3	99mm	19mm
10-56	0	52mm	8mm
10-57	1	83mm	16mm
10-58	2	95mm	19mm
10-59	3	111mm	18mm



**seasure**  
FORGED & TESTED  
FOR SAFETY

## SMALL STRIP SHACKLES

P/No	DIM 'A'	DIM 'B'	WEIGHT
05-29	8mm	11.5mm	4g
05-30	10.5mm	15mm	7g
05-35	15mm	26mm	17g
25-21	10mm	17mm	11g
25-23	11.5mm	32mm	9g

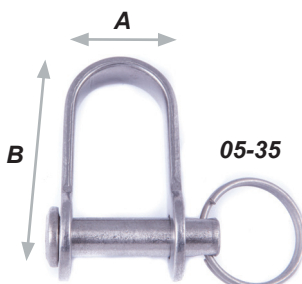

# SWIVEL SHACKLE

P/No	DESCRIPTION	WEIGHT
25-22	Swivel shackle fitted with 4.8mm diameter clevis pins. 11mm jaw width. 38mm between pins. Approx 450kg breaking load.	25g



# TWISTED SHACKLES

P/No	MATERIAL DIA.	DIM 'A'	DIM 'B'	BREAKING LOAD	WEIGHT
14-35	4mm	8mm	32mm	800kg	10g
14-36	5mm	10mm	36mm	1300kg	21g
14-37	6mm	12mm	42mm	2100kg	36g
14-38	8mm	16mm	55mm	3700kg	82g

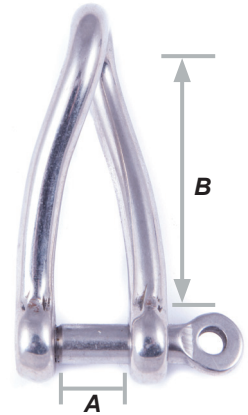

# BOW SHACKLES

P/No	MATERIAL DIA.	DIM 'A'	DIM 'B'	DIM 'C'	BREAKING LOAD	WEIGHT
14-24	4mm	8mm	21mm	15mm	900kg	9g
14-25	5mm	10mm	26mm	18mm	1200kg	15g
14-26	6mm	12mm	30mm	21mm	1800kg	30g
14-27	8mm	16mm	36mm	25mm	4300kg	68g
14-28	10mm	20mm	46mm	31mm	6200kg	139g
14-29	12mm	24mm	58mm	38mm	8400kg	258g
14-30	14mm	28mm	70mm	46mm	11600kg	382g

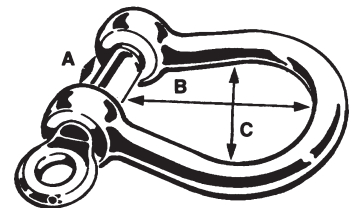

# BUDGET CAST LONG D-SHACKLES

P/No	Pin Diameter
40.88	5mm
40.89	6mm
40.90	8mm
40.91	10mm

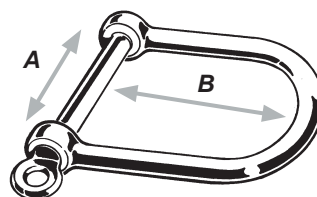



## BUDGET D-SHACKLES

D-Shackle Stainless steel with screw collar pin

P/No	Pin Diameter
40.72	4mm
40.73	5mm
40.74	6mm
41.60	8mm
41.61	10mm
40.75	12.5mm
40.76	16mm



D-Shackle St/steel with countersunk slotted pin

P/No	Pin Diameter
40.68	6mm
40.69	8mm
41.65	10mm



D Shackle Stainless steel with other pin type

P/No	Pin Type	Pin Diameter
40.86	Captive Pin	6mm
40.87	Hex headed screw pin 8mm	8mm
40.70	Allen screw pin	10mm
40.71	Allen screw pin	12mm

D Shackle Stainless steel with slotted pin

P/No	Pin Type
41.51	5mm
41.52	6mm
41.53	8mm



## BUDGET TWISTED SHACKLES

P/No	Pin Diameter
40.84	6mm
41.64	8mm
40.85	10mm



40-86



40-87



## BUDGET STRIP SHACKLES

P/No	Pin Diameter
40.58	4mm
40.59	5mm
40.60	6mm
40.61	8mm



## BUDGET BOW SHACKLES

P/No	Pin Diameter
40.77	4mm
40.78	5mm
40.79	6mm
40.80	8mm
40.81	10mm
40.82	12.5mm
40.83	16mm



## BUDGET SNAP SHACKLES

### Fixed Snap Shackle Stainless Steel

P/No	Pin Dia	Overall length
41.09	6mm	55mm
41.08	8mm	70mm
41.07	11mm	100mm



### Swivel Snap Shackle St/Steel

P/No	Pin Dia	Overall length
41.06	6mm	70mm
41.05	8mm	90mm
41.04	11mm	125mm



### Jaw swivel snap shackle St/Steel with clevis pin

P/No	Pin Dia	Overall length
41.10	6mm	70mm
41.11	8mm	85mm
41.12	11mm	130mm



## BUDGET EYE BOLTS

### SHOULDERED EYE BOLT STAINLESS STEEL

P/No	Thread Size
40.41	M8
40.42	M10



### RING BOLT STAINLESS STEEL

P/No	Thread Size
40.43	M6
40.44	M8
40.45	M9
40.46	M12



## BUDGET LINK SHACKLES

P/No	Material Diameter
40.20	5mm
40.21	6mm
40.22	8mm



## BUDGET SHACKLE KEY



P/No: 40.07

# METRIC U-BOLTS

Stainless steel U-bolts with plastic nuts on upper (low stress) side.  
 Part numbers ending with 'U' have round heads.  
 Part numbers ending with 'V' have angular heads.

P/No	THREAD SIZE	DIM 'A'	DIM 'B'	DIM 'C'
20 M4 25U	M4	26mm	26mm	25mm
20 M4 50U	M4	26mm	26mm	50mm
20 M4 25V	M4	26mm	26mm	25mm
20 M4 50V	M4	26mm	26mm	50mm
20 M5 25U	M5	26mm	30mm	25mm
20 M5 50U	M5	26mm	30mm	50mm
20 M5 75U	M5	26mm	30mm	75mm
20 M5 25V	M5	26mm	30mm	25mm
20 M5 50V	M5	26mm	30mm	50mm
20 M5 75V	M5	26mm	30mm	75mm
20 M6 25U	M6	35mm	35mm	25mm
20 M6 50U	M6	35mm	35mm	50mm
20 M8 35U	M8	44mm	45mm	35mm
20 M8 60U	M8	44mm	45mm	60mm
20 M10 50U	M10	55mm	60mm	50mm
20 M10 75U	M10	55mm	60mm	75mm
20 M12 50U	M12	70mm	70mm	50mm
20 M12 75U	M12	70mm	70mm	75mm

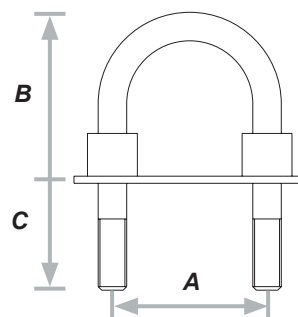

# CONCEPT U-BOLTS

It is difficult to believe that so many new and patented features could be included in a "U" bolt! The "Concept" range have been designed from first principles to offer unrivalled levels of protection from water ingress. They also include many features to enable fast and neat fitting, reducing installation costs for boat builders.

P/No	THREAD SIZE	DIM 'A'	DIM 'B'	DIM 'C'
30 M4 25U	M4	26mm	27mm	25mm
30 M4 50U	M4	26mm	27mm	50mm
30 M5 25U	M5	26mm	27mm	25mm
30 M5 50U	M5	26mm	27mm	50mm
30 M5 75U	M5	26mm	27mm	75mm
30 M6 25U	M6	35mm	36mm	25mm
30 M6 50U	M6	35mm	36mm	50mm
30 M8 35U	M8	44mm	47mm	35mm
30 M8 60U	M8	44mm	47mm	60mm
30 M10 50U	M10	55mm	50mm	50mm
30 M10 75U	M10	55mm	50mm	75mm
30 M12 50U	M12	70mm	62mm	50mm
30 M12 75U	M12	70mm	62mm	75mm



Patent Seal on Stainless Bolts

Features include:

- Unique deck seal for maximum protection from water ingress (patent applied for).
- Specially designed sealant pocket and slotted base plates for faster neater installation.
- New cup design evenly distributes load for maximum strength, durability and improved sealing capability (patent applied for).
- Manufactured in the UK by SeaSure from top grade 316 Stainless Steel for guaranteed quality.

## BUDGET U-BOLT

Stainless Steel

P/No	Material Dia.	Thread
40.23	4mm	M4
40.24	5mm	M5
40.25	6mm	M6
40.26	8mm	M8
40.27	10mm	M10
40.28	12.5mm	M12.5



## CLAMP PLATES

Clamp plates supplied with nylon lock nuts. The nylon lock nuts are designed to be level with the bottom of the thread. If you wish to tighten further, please use standard nuts.

P/No	DESCRIPTION	WEIGHT
25.02	Clamp Plate, 25mm (1") to 25mm (1")	235g
25.03	Clamp Plate, 25mm (1") to 25mm (1.5")	253g

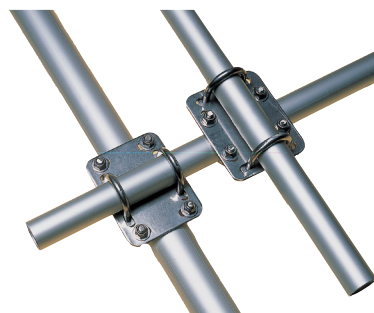

## BUCKLES

### NYLON WEBBING BUCKLES

These cost effective buckles are designed to resist webbing slip, even under nil-load conditions.

P/No	WEBBING SIZE	APPROX. BREAKING LOAD
06-96	40mm	300kg
06-98	50mm	300kg



06-96 / 06-98

### QUICK RELEASE BUCKLE

These light-weight push-close buckles are very simple to operate.

P/No	WEBBING SIZE	APPROX. BREAKING LOAD
19-58	40mm	200kg
19-60	50mm	200kg



19-58

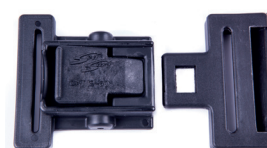

19-60

# BUCKLES

We manufacture a wide range of buckles for use on trapeze and safety harnesses as well as life jackets. They can also be used for adjusting the tension of webbing wherever it is used on the boat including toe straps. The frames are manufactured from 316 stainless steel for strength and corrosion resistance. The crossbars are available in plastic or black anodised aluminium depending on loading requirements.

## SLIDING BAR BUCKLES

Plastic closed end bar

P/No	WEBBING SIZE	APPROX. BREAKING LOAD
05-90	30mm	275kg
05-92	40mm	275kg
05-94	50mm	250kg



Plastic open end bar

P/No	WEBBING SIZE	APPROX. BREAKING LOAD
06-70	30mm	250kg
06-74	40mm	175kg
06-78	50mm	110kg



Aluminium bar

P/No	WEBBING SIZE	APPROX. BREAKING LOAD
06-71	20mm	1500kg
06-72	30mm	1500kg
06-76	40mm	1500kg
06-80	50mm	1500kg

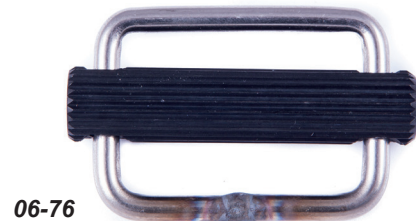

A new range of bar buckles combining great looks with excellent performance. These innovative buckles can be used in two modes, with the fixed (stitched) webbing attached either to the fixed plastic moulding or to the stainless steel frame.

P/No	WEBBING SIZE	APPROX. BREAKING LOAD
05-80	25mm	220kg
05-81	30mm	220kg
05-82	40mm	220kg
05-83	50mm	220kg

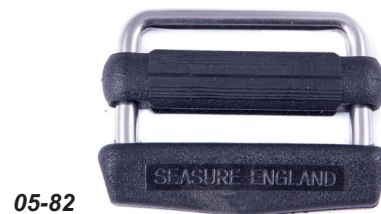

## MOUNTING PLATES

Mounting plates for Sliding Bar Buckles.

P/No	DESCRIPTION
25-48	Mounting plate for 50mm sliding bar buckle i.e. 06-78 or 06-80
25-49	Mounting plate for 50mm sliding bar buckle i.e. 06-78 or 06-80. This version has 9.5mm diameter holes to facilitate bonding into GRP.



# BUCKLES

## WEBBING PLATES

Designed to retain webbing ends of Toe Straps etc.

P/No	HOLE CENTRES
25-13	32mm
25-14	43mm



## BUCKLE TOE STRAP PLATE

P/No	DESCRIPTION
25-47	Buckle Toe Strap Plate. Accepts up to 50mm webbing.

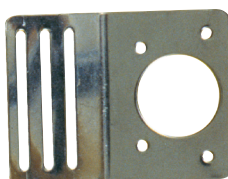

## BUCKLE FRAME

P/No	DESCRIPTION
25-97	Wire frame for 50mm webbing

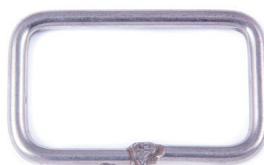

## WEBBING BRIDGES

3 Sizes of webbing bridge used to keep webbing secure and tidy.

P/No	DESCRIPTION
05-96	Bridge for 25mm webbing
05-97	Bridge for 40mm webbing
05-98	Bridge for 50mm webbing



# STAINLESS STEEL BUCKLES



06-68/06-82/06-84



08-46



06-83



08-02/08-04



08-10



06-85



08-12

P/No	DESCRIPTION	MATERIAL THICKNESS
06-68	3-bar (2 slot) buckle for 25mm webbing	1.6mm
06-82	3-bar (2 slot) buckle for 40mm webbing	2.6mm
06-84	3-bar (2 slot) buckle for 50mm webbing	2.6mm
06-83	4-bar (3 slot) buckle for 40mm webbing	3.2mm
08-10	3-bar (2 slot) buckle for 40mm webbing	3.2mm
08-12	Cage for 08-10	3.2mm
08-46	3-bar (2 slot) safety flat buckle for 45mm webbing	2.5mm
08-02	3-bar (2 slot) ribbed buckle for 30mm webbing	1.6mm
08-04	3-bar (2 slot) ribbed buckle for 40mm webbing	1.6mm
06-85	50mm webbing loop	2.6mm

# HASP AND STAPLES

A stylish range of hinges fabricated in 316 stainless steel and electro-polished for a long lasting high finish. The pins of the hinges and hasps and staples are welded in position for added security. The anti-rattle hasp and staple is designed for those who would like to get some sleep on their boat. The staple is fitted with pads to give a unique anti-rattle feature. The twist lock is also fitted with a carbon washer to ease the twist and lock mechanism.

P/No	DESCRIPTION	LENGTH CLOSED
23-00	Small hasp and staple	52mm
23-04	Anti-rattle hasp and staple	78mm
23-05	Anti-rattle hasp and staple	97mm
23-08	Large hasp and staple	78mm
23-09	Large hasp and staple	97mm

P/No	DESCRIPTION
23-02	Staple only from 23-00
23-10	Staple only from 23-08/23-09
23-15	Hasp and staple designed to compliment hinges 23-12 and 23-13
23-17	Staple only from 23-15



23-00



23-02



23-04/23-05



23-08/23-09



23-10



23-15



23-17

# HINGES

Superbly engineered stainless steel hinges with welded hinge pins. New 20mm width now available.

P/No	DESCRIPTION	DIM 'A'	DIM 'B'	DIM 'C'
23-12	Back flap hinge	73mm	-	33mm
23-13	Half back flap hinge	73mm	33mm	33mm
23-14	Stub hinge	-	33mm	33mm
23-20	Back flap hinge	93mm	-	39mm
23-21	Half back flap hinge	93mm	41mm	39mm
23-22	Stub hinge	-	41mm	39mm

P/No	DESCRIPTION	DIM 'A'	DIM 'B'	DIM 'C'
23-24	Back flap hinge	113mm	-	52mm
23-25	Half back flap hinge	113mm	54mm	52mm
23-26	Stub hinge	-	54mm	52mm
23-27	Back flap hinge	51mm	-	20mm
23-28	Half back flap hinge	51mm	24mm	20mm
23-29	Stub Hinge	-	24mm	20mm



23-12



23-13



23-14



23-24



23-25



23-26



23-20



23-21



23-22

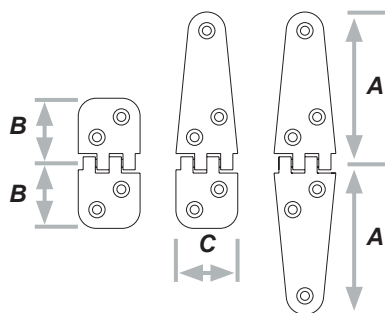

## COCKPIT SAFETY EYE

**“ADMIRABLY UNOBTRUSIVE IN THE COCKPIT – AND IT DOES NOT INDUCE ERRORS IN YOUR COMPASS!”**

This lightweight and strong safety eye is manufactured from 316 stainless steel and is designed so that the safety hook can not be accidentally released. The rubber stopper holds the eye firmly shut when not in use.

Breaking load: 2200 kg

P/No	DESCRIPTION	BREAKING LOAD
08-00	Cockpit safety eye	200 kg



08-00

## HARNESS SAFETY CATCHES

P/No	DESCRIPTION	WEBBING SIZE
08-30	Harness safety catch	Shoulder, 30mm
		Chest, 40mm
08-44	Harness safety catch	45mm



08-30



08-44

## LIFE LINE LINK

These webbing links are proving extremely popular due to their simplicity. Fitted or removed in seconds, they provide very strong attachment for deck safety lines or sheet locks. The larger version is designed to fit scaffold poles or theatre lighting barrels.

P/No	TO FIT TUBE DIAMETER
08-05	25mm
08-06	48mm

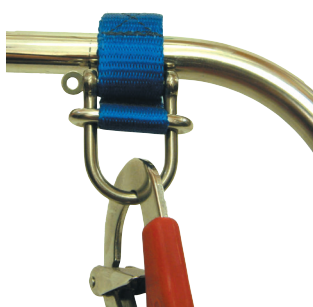

08-06



08-05

## HATCH LOCK

P/No	Description
23-35	Used to secure the sliding hatch to the washboards, this hatch lock can be operated from the cabin or the cockpit. Provision for padlock. Suitable for washboards up to 19mm thick.

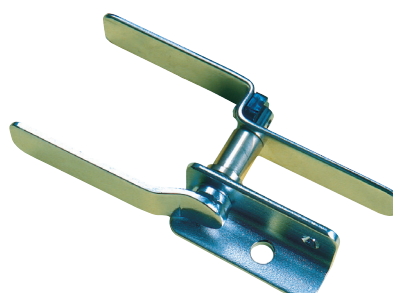



# ON-BOARD COMFORT & DISTRIBUTION

Blakes of Gosport can trace it's origins as far back as 1792, building equipment for Nelson's navy.

Classic Blakes & Taylors cookers, heaters and toilets are now built by us here in Warsash.

Along with these beautiful, individually crafted, iconic pieces we distribute other products for discerning yachtsmen and women. Our aim is to provide the best products from around the world that make the stay or journey on your boat even better.

We are always up-dating these products and ranges, so please contact us for the latest information and availability.

# MARINE TOILETS & SEACOCKS

Classic sea toilets and seacocks, hand built to the highest standards.  
A thing of beauty that stands the test of time.

## Blakes OF GOSPORT

Blakes Baby and Victory marine toilets are hand-built, using the finest, marine grade materials to withstand the rigours of marine environment. Offering yachtsmen all over the world an exceptionally long working life Blakes marine toilets are renowned throughout the sailing fraternity. The reliability of the simple classic design is such that original models from the 1920's are still in use, and 30 to 40 year old examples are common.

### Features:

- Castings manufactured in bronze to give maximum corrosion resistance
- Separate pumping systems ensure that clean water and waste are never mixed
- Suitable for use with holding tank
- Safely fitted above or below water line
- Oval, easy to clean vitreous white china pan
- At minimal extra cost you can specify left hand pumps set up

### MODEL BABY BLACK

P/No	Description
TBB0717	Baby Blake Right Hand White Seat & Lid

### MODEL VICTORY

P/No	Description
TBV0859	Blakes Victory Right Hand White Seat & Lid



### SEAT OPTION

*Large range of different colour finishes available*

## TOILET SPARE PARTS

## Blakes OF GOSPORT

P/No	Description
TBB0782	Baby Blake extended cruising spares kit
TBV0881	Blakes Victory extended cruising spares kit



# Blakes OF GOSPORT

## SEACOCKS

When the only thing between you and the ocean is a seacock, it makes sense to be certain that it is the very best design and quality possible. Structurally sound and manufactured to specifications approved by organisations such as Lloyds and the MOD, these essential items are manufactured from the very highest specification marine grade metals and feature unique, built-in grease nipples to allow in-water servicing. We also supply specially formulated seacock grease.

P/No	Description
SCXP210C	1 1/2" Seacock Complete

Spares	
SCXK11	Discharge plates for 1 1/2" 4 x nuts and bolts

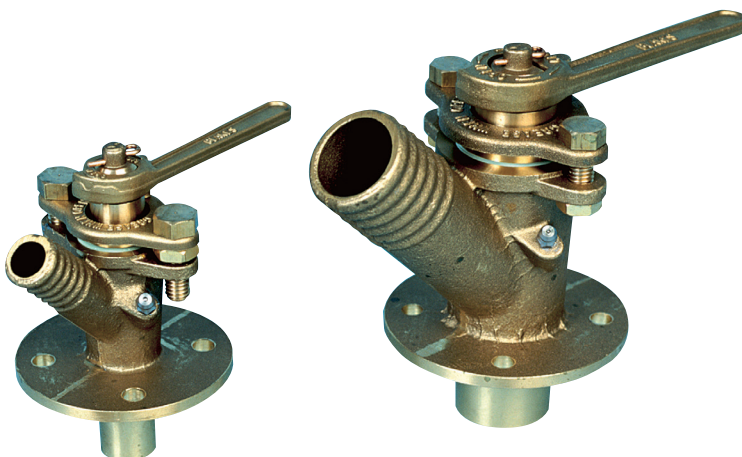

P/No	Description
SCXP110C	3/4" Seacock Complete

Spares	
SCXK22	Strainer plate for 3/4" 4 x nuts and bolts

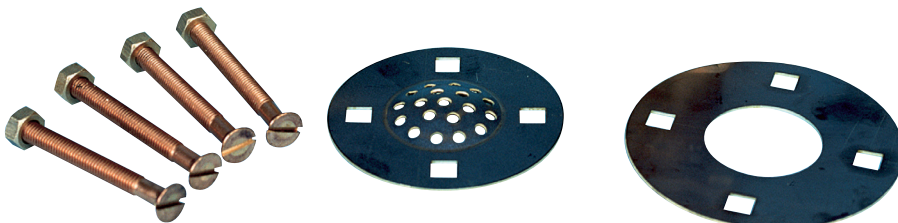

P/No	Description
SCX6007	Seacock tGrease



# LAVAC TOILETS

**“THE WORLDS MOST RELIABLE SEA TOILET”**

**“VACUUM FLUSHING, NO MOVING PARTS AND EXCEPTIONAL RELIABILITY MAKES THIS THE MARINE TOILET THAT OTHERS TRY TO MATCH”**



The LAVAC has earned the reputation of being the World’s most reliable sea toilet. Since its introduction, its patented vacuum flushing method has not been equalled by any other system. After use, simply close the seat and lid to complete the closed circuit seal. As waste is pumped out, the vacuum formed draws in replacement flushing water.

This simple, well-proven marine toilet will give continuous trouble free service and can be installed above or below the waterline.

It is particularly suitable for holding tank applications due to its minimal use of flushing water.

## LAVAC TOILETS – HOW THEY WORK

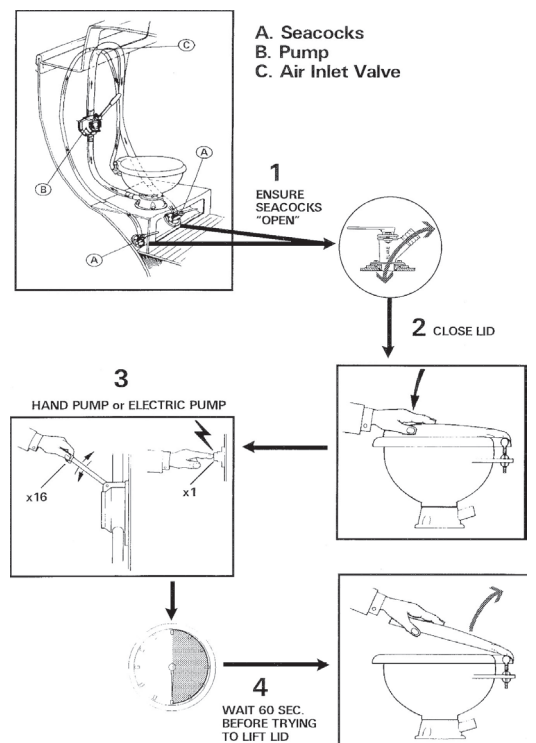

**SUPPLIED WITH LAVAC SANITARY HAND PUMP OR ELECTRIC PUMP**

# LAVAC POPULAR TOILET

New improved low profile Lavac Popular toilet.

The Lavac POPULAR is easily installed above or below the waterline. The patented vacuum flushing system is ideal for holding tanks where minimal flushing water is used.

It is easy to clean and no moving parts minimises maintenance.

The Lavac POPULAR is supplied with a hard wearing Lavac sanitary pump - with a choice of either manual or electric pump.



## POPULAR MODEL

P/No	Description
TLZ0801	Popular T/A Hand Pump
TLZ0802	Popular U/D Hand Pump
TLZ0809	Popular No Pump
TLZ0803	Popular 12V Electric Pump
TLZ0804	Popular 24V Electric Pump

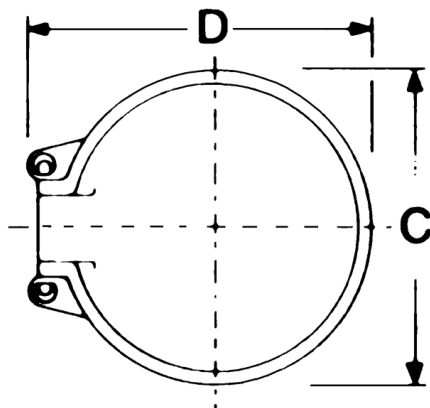
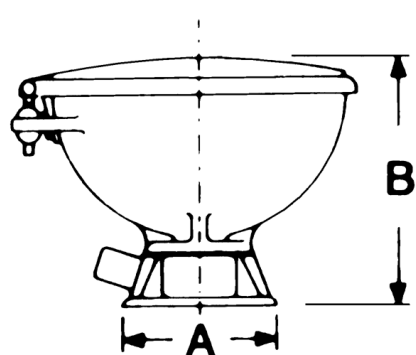

SIZES:

- A: 185 mm
- B: 352 mm
- C: 343 mm
- D: 416 mm

WEIGHT: 7.2 kg

## UNIVERSAL ADAPTER

### NEW 'EASY FIT' LAVAC UNIVERSAL MOUNTING BASE

The new easy fit base allows you to install the lavac popular into the same holes that are commonly found on yachts.

P/No TLZ0805

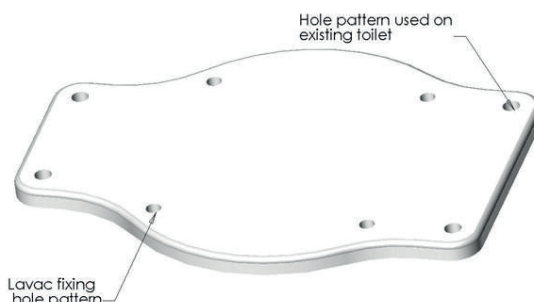

# LAVAC

## POPULAR & ZENITH TOILET SPARE PARTS

### POPULAR SPARES

TLZ8067KNEW	Set of seals
TLZ8068	Lid and seal assembly
TLZ0852	Universal spares kit
TLZ9191	Jabsco electric spares kit
TLZ9056NEW	TMC electric pump spares kit
TLZ0951	Henderson MK5 hand pump and electric spares kit

### ZENITH SPARES

TLZ9065	Seal for set or lid, 2x required to make set
TLZ9068	Lid and seal assembly, not including hinge
TLZ0952	Universal spares kit
TLZ0951	Henderson MK5 hand pump and electric spares kit



## MARINE PUMPS

### SURE 12VOLT MACERATOR PUMP

Part No. 65.05

12V Macerator Pump  
 Power source: DC 12V  
 Inlet Diameter: 1 1/2"  
 Outlet Diameter: 1"  
 Current: 12 A  
 Delivery Head: 16 FT  
 Self-Priming up to 5 FT

### SURE 24VOLT MACERATOR PUMP

Part No. 65.06

24 V Macerator Pump  
 Power source: DC 24V  
 Inlet Diameter: 1 1/2"  
 Outlet Diameter: 1"  
 Current: 6 A  
 Delivery Head: 16 FT  
 Self-Priming up to 5 FT



# LAVAC SANITATION PUMPS

Evolved from our long and continuous research into marine pumps, these powerful and reliable pumps offer a long, trouble free working life. When it comes to fluid and semi-solid pumping, the Lavac pump is the best solution.

**Features:**

- Manufactured from corrosion resistant, marine grade materials
- Designed to give long and trouble free service
- Quick release inspection cover high quality, lightweight, ABS plastic body
- 38mm (1 1/2") inlet / outlet
- Various mounting position
- Large non-choke valves
- Tough plastic keeps in nasty smells
- Easy to service (no tools required)

## ELECTRIC PUMP

- Available in 12 or 24 Volts.
- Quiet operation
- Low power consumption 15 flushes from 1Ah

P/No	Description
TLZ9180	Electric 12 volt Pump
TLZ9190	Electric 24 volt Pump

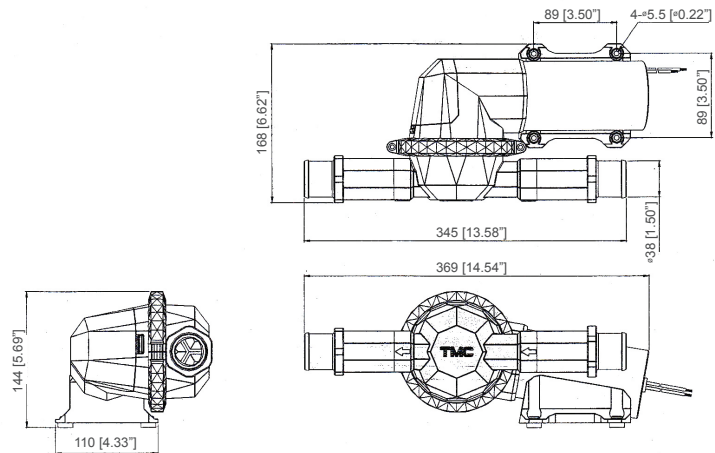

## MANUAL PUMP

- Output: 56 litres per minute

P/Not	Description
TLZ9090	Hand Pump T/A(Top Action)
TLZ9095	Hand Pump U/D (Behind Bulkhead)
TLZ0951	Hand pump spare kit

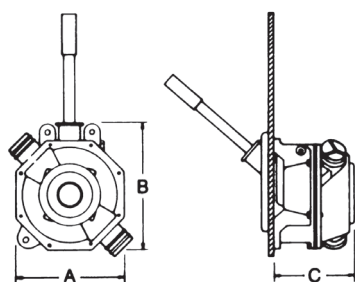

A: 170 mm  
B: 200 mm  
C: 140 mm

# TAYLOR'S PARAFFIN COOKERS

With its gleaming brass trim and polished stainless steel body. A Taylors cooker will compliment either a modern or classic galley.

Paraffin cookers are the ideal solution for the owner who chooses not to carry gas on board.

Features:

- Self pricking and regulating burners
- Gimbals, fiddle rail and pan clamps
- Supplied complete and ready to install with full fixing kit
- Includes a 1.5 gallon stainless steel tank
- Includes tool kit & burner spares kit

## MODEL 030 AND 030L

- 2 Burner hob & grill facility with separate oven and burner
- Large cast iron hot plates

P/No	Dimension (lxdxh)
CTK0230L	C: 534mm inc. gimble J: 464mm inc. handle A+B: 509mm inc. fiddle rod
CTK0230	C: 574mm inc. gimble J: 329mm inc. handle A+B: 509mm inc. fiddle rod

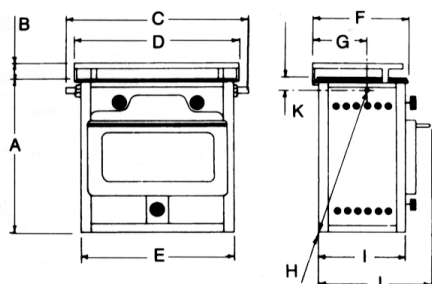

**“STRONG, ATTRACTIVE, RELIABLE, SAFE”**

## MODEL 029

- 2 Burner hob & warming oven
- Large cast iron hot plates

P/No	Dimension (lxdxh)
CTK0229	C: 521mm inc. gimble J: 285mm inc. handle A+B: 360mm inc. fiddle rod

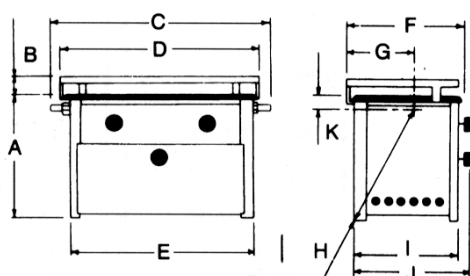



# TAYLOR'S PARAFFIN COOKERS

## MODEL 028

- 2 Burner hob & grill
- Large cast iron hot plates

P/No	Dimension (lxdxh)
CTK0228	C: 537mm inc. gimble J: 285mm inc. control knob A+B: 240mm inc. gimble

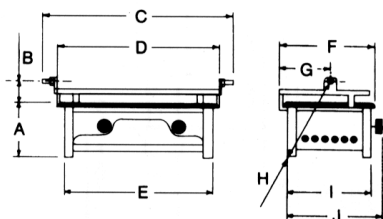

## MODEL IDEALK

- The ideal entry level paraffin cooker 2 Burner hob

P/No	Dimension (lxdxh)
IDEALK	477 x 272 x 135mm



## COOKER DIMENSIONS

030 Paraffin	030L Paraffin	029 Paraffin	028 Paraffin
A – 18" (458mm)	18 1/4" (464mm)	12 1/2" (317mm)	6 1/2" (170mm)
B – 2 1/4" (43mm)	2 1/4" (45mm)	2 1/4" (43mm)	4 1/4" (70mm)
C – 21 1/8" (537mm)	21 1/8" (537mm)	21 1/8" (521mm)	22 1/8" (537mm)
D – 18 1/2" (470mm)	18 1/2" (470mm)	18 1/2" (470mm)	18 1/4" (470mm)
E – 17 1/2" (443mm)	17 1/2" (445mm)	17 1/2" (443mm)	17 1/2" (443mm)
F – 11" (277mm)	16" (407mm)	11" (273mm)	11" (273mm)
G – 6 1/2" (162mm)	9" (216mm)	6" (140mm)	5 3/4" (144mm)
H – 17 3/4" (446mm)	18 1/2" (470mm)	11 1/2" (290mm)	11 1/4" (280mm)
I – 10" (255mm)	15" (381mm)	10" (255mm)	10" (255mm)
J – 13" (329mm)	18 1/4" (464mm)	11 1/4" (285mm)	11 1/2" (285mm)
K – 1 1/2" (38mm)	1 1/2" (39mm)	2" (51mm)	

## COOKER SPARES

Spare parts: suitable for all models

P/No	Description
CTK1035P4GER	Tested Burner complete
CTK1062	Burner spares kit for 2 burners
CTKNOR	Normal spares kit

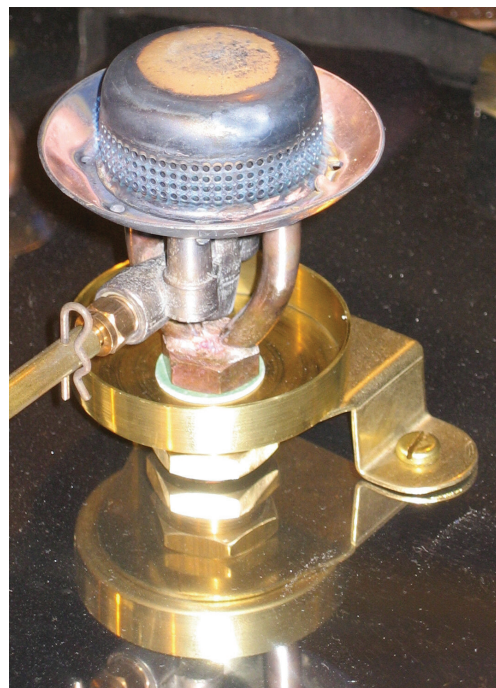

# TAYLOR'S HEATERS – PARAFFIN

**“EXTEND YOUR SEASON AND GET MORE OUT OF YOUR YACHTING WITH A SUPERBLY CRAFTED CLASSIC TAYLORS HEATER”**

## MODEL 079K PARAFFIN HEATER

The paraffin (Kerosene) version of this much-loved heater is fuelled from its own pump pressurised supply tank. The burner accessed from the front opening door is self cleaning and self pricking and like all Taylor's burners extremely reliable. This model provides a dry heat thus reducing condensation.

P/No	Description
HTK0531	Model 079 Kerosene Stainless Steel Front
HTK0521	Model 079 Kerosene Brass Front

### Features:

- Made of robust, high quality materials
- 2.1kw output
- Front opening door gives access for maintenance or adjustment.
- Supplied with 1.5 gallon tank, a safety on/off fuel control valve, in-line fuel filter, pipe work and fittings for installation.
- Externally vented and bulkhead mounted.
- Through-deck fitting flue sections also supplied.
- Stainless steel or Brass Front.

Option: To run both a heater and cooker from the same tank you will need:

CTK2405 Fuel line equal "T" 3/16" connection

### Taylor's Heaters Spare Parts:

HTKNOR	Paraffin heater normal kit
CTK1062	Paraffin burner spares kit for 2 burners
CTK1035P4GER	Tested Complete paraffin burner



*Available in Brass or Stainless Steel finish*

# TAYLOR'S HEATERS – DIESEL

## MODEL 079D DIESEL HEATER

Fuelled by generally available diesel, either from its own gravity tank (Header Tank version) or pumped direct from the boat's supply (main fuel tank version). The main fuel tank version Diesel cabin heater requires an electric supply which only uses 0.25 Ah per day.

### HEADER TANK VERSION

HTD0511	Model 079 Diesel Stainless Steel Front
HTD0501	Model 079 Diesel Brass Front

### MAIN FUEL TANK VERSION (PUMPED)

HTD0511P	Model 079 Diesel Stainless Steel Front
HTD0501P	Model 079 Diesel Brass Front

### Taylor's Heaters Spare Parts:

HTDNOR	Diesel heater normal kit
--------	--------------------------

*Available in Brass or Stainless Steel finish*



# GOURMET SERIES 2 GRILLS INFRARED

- Infrared Technology
- Piezo Igniters
- 100% mirror polished 18-9 stainless steel
- Glass viewing panel
- Fully double lined safety shells
- Thermometers
- Folding Legs

## 'MONTEREY' INFRARED GAS GRILL

### 50.171

Grill area	2710 sq. cm	(420 sq. in.)
Primary	30 cm x 61 cm	(12 x 24 in.)
Secondary	14 cm x 61 cm	(5-1/2 x 24 in.)

## 'CATALINA' INFRARED GAS GRILL

### 50.166

Grill area	2032 sq. cm	(315 sq. in.)
Primary	30 cm x 46 cm	(12 x 18 in.)
Secondary	14 cm x 46 cm	(5-1/2 x 18 in.)

## 'NEWPORT' INFRARED GAS GRILL

### 50.169

Grill area	1045 sq. cm	(162 sq. in.)
	23 cm x 46 cm	(9 x 18 in.)



# CLASSIC GOURMET SERIES 2

## 'MONTEREY' GAS GRILL

### 50.170

Grill area	2710 sq. cm	(420 sq. in.)
Primary	30 cm x 61 cm	(12 x 24 in.)
Secondary	14 cm x 61 cm	(5-1/2 x 24 in.)

## 'CATALINA' GAS GRILL

### 50.167

Grill area	2032 sq. cm	(315 sq. in.)
Primary	30 cm x 46 cm	(12 x 18 in.)
Secondary	14 cm x 46 cm	(5-1/2 x 18 in.)

## 'NEWPORT' GAS GRILL

### 50.168

Grill area	1045 sq. cm	(162 sq. in.)
	23 cm x 46 cm	(9 x 18 in.)



**Serving shelves sold separately, fuel canisters not included**

All replacement parts for all Magmas products past and present are readily available and ready to ship.

# CONNOISSEUR GRILLS

- Folding Legs
- 100% mirror polished 18-9 stainless steel
- 2-Piece Stainless Grease Diverter System

## TRAILMATE™

50.78

Grill area	23 x 30.5 cm	(9 x 12 in.)
	697 sq. cm	(108 sq. in.)

## CHEFSMATE™

50.54

Grill area	(23 x 46 cm)	(9 x 18 in.)
	(1045 sq. cm)	(162 sq. in.)



# ADVENTURER GRILLS

- Folding Legs
- 100% mirror polished 18-9 Stainless Steel

## CABO™ GAS GRILL

50.88

Grill area	(23 x 46 cm)	(9 x 18 in.)
	(1045 sq. cm)	(162 sq. in.)



# MARINE KETTLE GRILLS – CHARCOAL

- Adjustable “Wind Block” Lids
- Complete Temperature Control
- 100% mirror polished 18-9 Stainless Steel

50.02

Original Size Diameter	38cm	(15 in.)
------------------------	------	----------

50.03

Party Size Diameter	43cm	(17 in.)
---------------------	------	----------



**Serving shelves and Mounts sold separately, fuel canisters not included**

All replacement parts for all Magmas products past and present are readily available and ready to ship.

## MARINE KETTLE GRILLS – GAS

- Adjustable “Wind Block” Lids
- 100% mirror polished 18-9 Stainless Steel

### 50.01

Original Size Diameter	38cm	(15 in.)
------------------------	------	----------

### 50.94

Party Size Diameter	43cm	(17 in.)
---------------------	------	----------



## MARINE KETTLE 3 COMBINATION STOVE AND GAS GRILL

- 100% mirror polished 18-9 Stainless Steel
- Fully Double Lined Safety Shells
- Hinged Lids
- Adjustable “Wind Block” Lids
- Piezo Igniters
- Iso Use As One Burner Stove

### 50.189

Party Size Diameter	43cm	(17 in.)
---------------------	------	----------

### 50.183

Original Size Diameter	38cm	(15 in.)
------------------------	------	----------



## GRILL COVERS

Our premium covers made of water and fade resistant Sunbrella®, the finest name in boat cover materials, to resist damage from sunlight and mildew.

5 year warranty covers the fabric becoming unserviceable because of loss of color or strength from normal exposure conditions, including sunlight, mildew, rot & atmospheric chemicals. 1 year warranty on all other components.

**Available in boatings most popular colours**

### Magma® Marine Kettle Grill Cover

Fits all Original size

Fits all party size

### Magma® Rectangular Grill Covers

Fits Newport & Chefs Mate

Fits Catalina

Fits Monterey



\* Sunbrella and Glen Raven are registered Trademarks of Glen Raven Mills, Inc.

# MOUNTS – RECTANGULAR GRILLS & TABLES

## MOUNTS - Rectangular Grills & Tables

50.116	71cm (28") Double Locking Stowable Pedestal Mount
50.37	"LevelLock"® All-Angle Fish-Rod Holder Mount

## "Single" Horizontal Round Rail Mount

50.08	Standard Rails	22 mm or 25.5 mm (7/8" or 1")
50.73	Oversize Rails	28.5 mm or 32 mm (1-1/8" or 1-1/4")
50.117	Large Rails	38 mm (1-1/2")

## "Dual" Extended Horizontal Round Rail Mount

50.47	Standard Rails	25.5 mm (1")
50.49	Oversize Rails	32 mm (1-1/4")
50.118	Large Rails	38 mm (1-1/2")

## "Dual" Horizontal Round Rail Mount

50.42	Standard Rails	22 mm or 25.5 mm (7/8" or 1")
50.65	Oversize Rails	28.5 mm or 32 mm (1-1/8" or 1-1/4")

## Vertical "LevelLock"® Round Rail Mount

50.57	Standard Rails	22 mm or 25.5 mm (7/8" or 1")
-------	----------------	-------------------------------



50.116



50.37



50.08 50.73 50.117



50.47 50.49 50.118



50.42 50.65



50.57

# MOUNTS – MARINE KETTLE GRILLS

## MOUNTS - Marine Kettles Grills

50.05	Surface Deck Socket Mount
50.44	Mounting Extension
50.15	POW'R GRIP™ Fish Rod Holder Mount
50.11	Side (Bulkhead) or Square/Flat Rail Mount
50.06	Shore Stand/Table Top Legs

## Round Rail Mount

50.04	Standard Rails	22 mm or 25.5 mm (7/8" or 1")
50.21	Oversize Rails	28.5 mm or 32 mm (1-1/8" or 1-1/4")



50.04 50.21



50.06

All replacement parts for all Magmas products past and present are readily available and ready to ship.

# MAGMA NESTING COOKWARE

## Gourmet Series Cookware

50.75	10 Piece "Nesting" 18-10 Mirror Polished Stainless Steel
50.77	7 Piece "Nesting" Starter Set 18-10 Mirror Polished Stainless Steel
50.143	10 Piece "Nesting" Stainless Steel Cookware Set with Ceramica® Non-Stick
50.144	10 Piece "Nesting" Stainless Steel Induction Cookware Set with Ceramica® Non-Stick
50.147	10 Piece "Nesting" Cobalt Blue Stainless Steel Cookware Set with Ceramica® Non-Stick
50.148	10 Piece "Nesting" Cobalt Blue Stainless Steel Induction Cookware Set with Ceramica® Non-Stick
50.185	10 Piece "Nesting" Jet Black Stainless Steel Induction Cookware Set with Ceramica® Non-Stick
50.186	10 Piece "Nesting" Magma Red Stainless Steel Induction Cookware Set with Ceramica® Non-Stick
50.187	Storage case for nesting cookware
50.164	Set of three Pot Protectors
50.149	Nesting colander
50.188	Professional Series Gourmet "Nesting" Stainless Steel Sauté/Omlette Pan with Ceramica® Non-Stick



50.75



50.77



Stows in less than .013 cubic meter (1/2 cubic foot)



50.186



10 PIECE SET  
Stores in less than 1/2 cubic foot



50.188



50.147

All replacement parts for all Magmas products past and present are readily available and ready to ship.

# ACCESSORIES



50.99

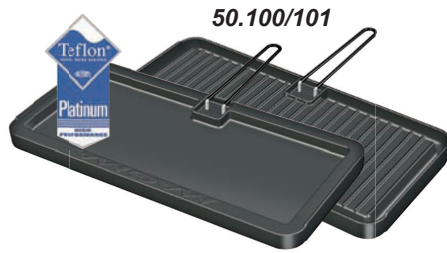

50.100/101



50.102

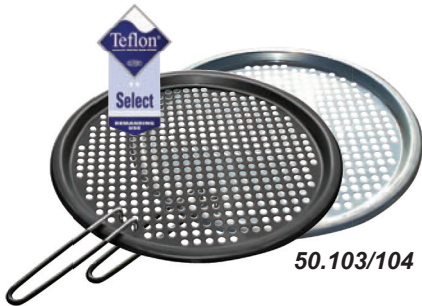

50.103/104



50.79

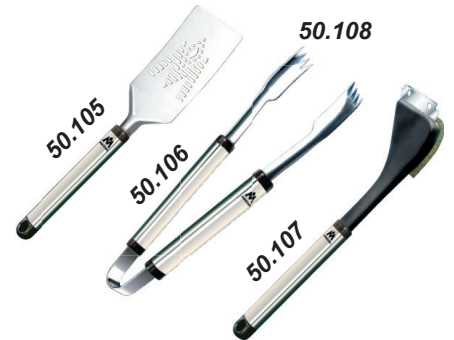

50.108

50.105

50.106

50.107



50.12



50.109



50.110

50.99	Fish & Veggie Grill Tray, 20 cm x 43 cm (8" x 17") Stainless Steel
50.100	Giddle Non-Stick-Reversible, 20 cm x 43 cm (8" x 17")
50.101	Giddle Non-Stick-Reversible, 28 cm x 43 cm (11" x 17")
50.102	100% All 18-8 Stainless Steel Wok, 42 cm diameter (16-1/2")
50.103	Fish & Veggie Grill Tray, 30 cm diameter (11-3/4"), Teflon Finish
50.104	Fish & Veggie Grill Tray, 30 cm diameter (11-3/4"), Stainless Steel Finish
50.79	Giddle Non-Stick-Reversible, 30 cm diameter (11-3/4")
50.105	Professional Grill Utensils - Spatula
50.106	Professional Grill Utensils - Tongs
50.107	Professional Grill Utensils - Grill Brush
50.108	Professional Grill Utensils - Complete 3 Piece Set
50.109	"Marine Cuisine"® Grill Guide & Cookbook
50.110	Easy Light™ Charcoal Starter

## Umbrella

50.152	UV 100% blocker
50.162	Black
50.163	Blue

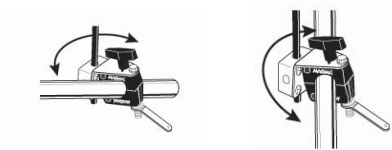

Fits Standard Size Round Rail  
22 mm to 25.5 mm (7/8" to 1")



50.152



50.162



50.163

All replacement parts for all Magmas products past and present are readily available and ready to ship.



**Serving Shelf with Removable Cutting Board**

50.50 44 cm x 19 cm (17-1/4" x 7-1/2")



**Padded Grill & Accessory Carrying Cases**

50.85 23 cm x 46 cm Grills (9 x 18")

50.83 30 cm x 46 cm Grills (12 x 18")

50.82 30 cm x 61 cm Grills (12 x 24")

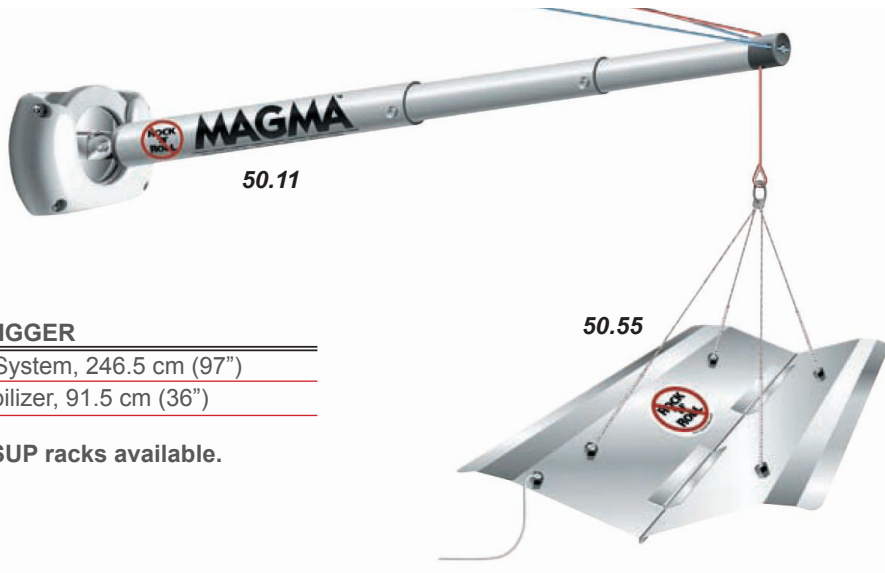

**ROCK 'N ROLL BOAT STABILIZER & OUTRIGGER**

50.11 The "Rock'n'Roll"™ Outrigger System, 246.5 cm (97")

50.55 The "Rock'n'Roll"™ Boat Stabilizer, 91.5 cm (36")

Magma boat and dock mounted kayak and SUP racks available. Please contact us for more info.

TOURNAMENT SERIES CLEANING STATIONS

**BAIT / FILET MATE**

**Econo Mate™ Bait & Filet Table**

50.23 31 cm x 41 cm (12" x 16")

**Bait/Filet Mate™ Table**

50.20 32.5 cm x 51 cm (12-3/4" x 20")

50.51 32 cm x 79 cm (12-1/2" x 31")

**Bait/Filet Mate™ Table with "Levelock"® Mount**

50.70 32.5 cm x 51 cm (12-3/4" x 20")

50.112 32 cm x 79 cm (12-1/2" x 31")



Please contact us for the full range of bait and filet tables



All replacement parts for all Magmas products past and present are readily available and ready to ship.

# KNIVES & TOOL KITS



The true original yachtsman knife. Crafted in the UK for unrivalled quality they can be supplied with or without lanyard and are the perfect gift item.

### Clasp Knife 85mm Bosun's Mate

Stainless steel clasp knife with a 50mm blade, locking spike and shackler.

P/No	Overall Length	Weight
12.00	85mm	100g
12.01	Bosuns mate with lanyard	



### Clasp Knife 95mm Bosun

Stainless steel clasp knife with a 76mm blade, locking spike and shackler.

P/No	Overall Length	Weight
12.03	95mm	110g
12.04	Bosun with lanyard	



### Clasp Knife 95mm Captain

Stainless steel knife with a 65mm blade, opener, spike and shackler.

P/No	Overall Length	Weight
12.06	95mm	110g
12.07	Captain with lanyard	



### Clasp Knife 80mm Deckhand

Stainless steel, single 70mm blade-only clasp knife, with a shackler built into the handle.

P/No	Overall Length	Weight
12.09	80mm	100g
12.10	Deckhand with lanyard	



### Green River Knife

Stainless steel knife complete with leather sheath blade cover and leather handle retainer.

P/No	Blade Length	Overall Length
12.12	130mm	229mm



### Seaman's Knife

Stainless steel blade complete with leather sheath

P/No	Blade Length	Overall Length
12.17	152mm	216mm



### 165mm spike & Shackler

Part No	Description
12.11	Stainless Steel shackler and splicing spike complete with leather sheath
12.02	Stainless Steel shackler and splicing spike



### Rigger's Sheath Knife

Part No	Description
12.16	A traditional rosewood handled knife with flat cutting edge stainless steel blade and leather sheath



12.14



12.19



12.20



12.13



12.18

Part Name	Part No.	Knife Overall Length	Blade Length	Spike Length	Pliers Length	Screwdriver Size	Spanner Jaw Size
Rigger's kit with adjustable spanner	12.14	200mm	100mm	165mm	152mm	n/a	150mmx20mm
Knife & spike set	12.19	200mm	100mm	165mm			
Rigger's kit with screwdriver	12.20	200mm	100mm	165mm	152mm	200mmx35mm	
Knife set with spike/shackler & pliers	12.13	200mm	100mm	165mm	152mm		
Full Rigger's kit	12.18	200mm	100mm	165mm	152mm	200mmx35mm	150mmx20mm

# TAPE

## PVC TAPE – GENERAL PURPOSE TAPE

- High quality general purpose PVC tape manufactured to BS3924
- Flame retardant (will self-extinguish if it catches fire)
- Good for electrical insulation, Taping groups of cables together, marking sliding block positions on spars and head sail block tracks
- Plastic roll to facilitate storage in wet condition

P/No	DESCRIPTION
51.29	PVC Tape 20m x 19mm blue
51.30	PVC Tape 20m x 19mm red
51.31	PVC Tape 20m x 19mm green
51.32	PVC Tape 20m x 19mm white
51.33	PVC Tape 20m x 19mm black
51.34	PVC Tape 20m x 19mm yellow



## RUBBAWELD – SELF-AMALGAMATING MARINE TAPE

This tape is a non-adhesive tape, it bonds to itself and not to your fittings.

- Ideal for rigging screws, terminals, on-deck electrics and emergency plumbing repairs.
- Withstands 100 deg C
- Makes neat and lasting terminations for rope ends

P/No	Description
51.00	Rubbaweld Tape 5m x 25mm black
51.01	Rubbaweld Tape 5m x 25mm white
51.02	Rubbaweld Tape 10m x 25mm black
51.03	Rubbaweld Tape 10m x 25mm white
51.04	Rubbaweld Tape 10m x 50mm black
51.05	Rubbaweld Tape 10m x 50mm white
51.06	Rubbaweld Mastboot 3m x 100mm Black



## RIPSTOP SPINNAKER REPAIR TAPE

This spinnaker and sail repair tape is a self-adhesive nylon tape and is ideal for reinforcing batten pockets and to carryout temporary repairs to torn sails. Can also be used to prevent chaffing.

- Other usage includes: Tear on clothing, tent, blind, umbrella
- Stick on PVC, Flexiglass or glass

P/No	DESCRIPTION
51.07	Ripstop 4.5m x 50mm white
51.08	Ripstop 4.5m x 50mm red
51.09	Ripstop 4.5m x 50mm royal blue
51.10	Ripstop 4.5m x 50mm light blue
51.11	Ripstop 4.5m x 50mm green
51.12	Ripstop 4.5m x 50mm black
51.13	Ripstop 4.5m x 50mm yellow
51.14	Ripstop 4.5m x 50mm orange
51.15	Ripstop 4.5m x 50mm purple
51.16	Ripstop 4.5m x 50mm pink
51.17	Ripstop 4.5m x 50mm lime yellow



# TAPE

## DUCT TAPE

Duct tape is a self adhesive waterproof cloth tape suitable for numerous repair jobs on all boats, dinghies and canoes. Available in 5 colors.

P/No	DESCRIPTION
51.21	Duct tape 50mm x 5m silver
51.22	Duct tape 50mm x 5m white
51.23	Duct tape 50mm x 5m red
51.24	Duct tape 50mm x 5m black
51.25	Duct tape 50mm x 5m blue
51.26	Duct tape 50mm x 5m silver
51.27	Duct tape 50mm x 5m black



## SAIL REPAIR TAPE

- Ideal for long lasting emergency sail repairs
- Suitable for all sails including heavy spinnakers
- Maintape and Kevlar tape can be edge stitched for a permanent repair
- Ideal for reinforcing batten pockets
- Great for anti-chafe applications. Apply to areas of sail that regularly come into contact with shrouds, spreader ends etc.

P/No	DESCRIPTION
51.18	Maintape - Heavy duty tape 1.5m x 100mm white
51.19	Mylar tape 3m x 50mm
51.20	Kevlar Heavy duty tape 1.5m x 50mm



## PTFE TAPE

Waterproof non-contaminating thread sealing tape for pipe connection and suitable for loose or tight fitting threads.

P/No	DESCRIPTION
51.42	PTFE tape 12m x 12mm



## HATCHSEAL TAPE

A rubber like strip on a self adhesive roll of tape. Perfect for sealing doors, hatches windows and also for bedding home fittings etc.

P/No	DESCRIPTION
51.35	Hatchseal Tape 3m x 19mm x 3mm black
51.36	Hatchseal Tape 3m x 19mm x 6mm black



# TAPE

## REFLECTIVE TAPE

- Reflectolite is a reflective self-adhesive yellow tape and ideal for night time identification given its light-reflection properties. Ideal for tenders, trailers and many on-board items.
- Daybrite is a daylight fluorescent self-adhesive tape perfect for lifejackets and sailing wear. Fluorescent orange.
- Reflexite is probably the brightest retro reflective tape on the market. Solas/DOT approved for safety equipment and life saving appliances.

P/No	DESCRIPTION
51.37	Reflectolite 5m x 19mm yellow
51.38	Daybrite 5m x 25mm fluorescent orange
51.39	Reflexite tape 1m x 50mm silver



## RIGGERS TAPE

High Quality waterproof cloth tape for many applications.

- Self adhesive
- Multiple anti-chafe applications, spreader ends, rigging screws, split pins etc
- Excellent for any other general repairs where narrow tape is required

P/No	DESCRIPTION
51.28	Riggers rape 10m x 25mm silver



## FINE LINE MASKING TAPE

A good quality low tack tape. Essential for most painting jobs on board.

P/No	DESCRIPTION
51.44	Fine line masking tape 65m x 19mm



## NON-SLIP DECK TAPE

P/No	DESCRIPTION
51.45	Non-slip deck tape 18m x 25mm
51.46	Non-slip deck tape 18m x 50mm



## HULLSTRIPE COVELINE

Tough, self adhesive and waterproof. Easy to apply.

P/No	DESCRIPTION
51.40	Hullstripe Coveline 10m x 15mm gold
51.41	Hullstripe Coveline 10m x 15mm silver



**1. GENERAL**

These terms and conditions of sale will form the basis of any contract between the Company and the Buyer and exclude any other terms and conditions inconsistent with them which the Buyer might seek to impose at any time. No variation of these terms and conditions is permitted unless expressly agreed in writing by a Director of the Company.

**2. CONSTRUCTION**

All contracts entered into by the Company will be subject to English Law and will be subject to the non-exclusive jurisdiction of the courts of England and Wales

**3. PRICES**

Unless Otherwise Stated any estimate or quotation provided by the Company will be valid for 30 days from the date of issue.

Goods will be invoiced at the price current at the date of despatch. The Company reserves the right to adjust the price at any time prior to delivery of the Goods to take account of increases in labour or material costs or currency fluctuations affecting imported Goods. Unless otherwise stated the quoted prices are net ex-works and are exclusive of carriage, insurance, packaging and VAT.

**4. DELIVERY**

Delivery is effected when the Goods leave the premises of the Company. Delivery dates are advised in good faith but the Company will not be liable for any loss caused by late delivery or its failure to make Goods available for collection on the due date.

The seller may deliver by instalments in such quantities as it may reasonably decide; such instalments shall be separate obligations and no breach in respect of one or more of them shall entitle the buyer to cancel any subsequent instalments or repudiate this contract as a whole.

**5. BREAKING LOADS**

The breaking loads given in this catalogue are for guidance only and are not guaranteed. They represent an average of tests carried out by ourselves using calibrated testing equipment.

**6. FORCE MAJEURE**

The Company shall not be liable for any failure to deliver the Goods arising from circumstances outside its control. These circumstances include, but are not limited to, the following:-

Act of God, war, riot, explosion, abnormal weather conditions, fire, flood, strikes, lockouts, Government (UK or other) actions or regulations, delay by suppliers, accidents, shortage of materials, labour or manufacturing facilities.

Should the Company be prevented from delivering in the above circumstances the Company will inform the Buyer as soon as reasonably practicable.

**7. RISK**

Risk in the Goods passes to the Buyer when the Goods are delivered to or collected by the Buyer or its agent.

**8. TITLE**

Title in the Goods shall not pass to the Buyer until the Goods have been paid for in full and all amounts owed by the Buyer to the Company for other Goods have been paid. So long as the Company is owed any amount by the Buyer, the Buyer may transfer title only as a fiduciary agent for the Company.

The Company may recover from the Buyer any Goods supplied by the Company if they have not been paid for, or if in the opinion of the Company serious doubts arise as to the solvency of the Buyer. In this situation the Company may enter upon any premises of the Buyer to remove such Goods.

**9. CLAIMS**

Goods shall be examined by the Buyer on delivery or collection, or should be signed for as 'unexamined'. Any shortages, damage or problems should be notified verbally within 3 days and in writing within 7 days of the date of delivery.

**10. PAYMENT**

All sums are due within 30 days of the date of delivery for credit account holders. In other cases payment will be required prior to delivery.

**11. RETURNS**

A restocking charge of 20% will be applied to all goods returned for credit due to error in ordering on the customers part, for whatever reason.

## IMPORTANT NOTICE

Product descriptions and illustrations contained in this catalogue are intended to give a general description only. Illustrations, sizes and descriptions are generally accurate but shall not be considered binding or part of a contract. SeaSure reserves the right to alter technical specifications without notice.

## CONTACT US

Tel: +44 (0) 1489 885 401  
 Fax: +44 (0) 1489 885 402  
 Email: [sales@sea-sure.co.uk](mailto:sales@sea-sure.co.uk)  
 Web: [www.sea-sure.co.uk](http://www.sea-sure.co.uk)

## ADDRESS

SeaSure Ltd  
 Clock Tower Works  
 Shore Road  
 Warsash  
 Hampshire SO31 9GQ  
 United Kingdom



# DISTRIBUTORS



Union Chandlery Ltd  
4-5 Penrose Quay  
Cork, Ireland  
Tel: +353 214554334



Oy Maritim AB  
PL 46, SF-00211  
Helsinki, Finland  
T: +358 968 1631



Nautilus Ltd  
Metamorfoseos 2  
Alimos 174-55  
Athens, GREECE  
Tel: +30 19854238



Robert Lindemann KG  
WendenstraBe 455  
D-20537 Hamburg  
GERMANY  
Tel: +49 402111970



Schaefer Marine Inc  
158 Duchaine Boulevard  
New Bedford, Massachusetts  
02745 - 1293, USA  
Tel: +1 508/995-9511



North West Marine Distributors  
26940 26th Avenue  
Aldergrove, British Columbia  
V4W2Y6, CANADA  
Tel: +1 6046077901



Belship BV  
Krommewetering 61A  
3543 AM Utrecht  
HOLLAND  
Tel: +31 302408040



Bucher & Walt SA  
Route de Soleure 8  
2072 St Blaise  
Neuchatel  
SWITZERLAND  
Tel: +41 32755



Teufelburger/Robship  
Bolshedens Indu 30  
S-427 50 Billdal  
Sweden  
Tel: +46 31 939100



TA France  
9 Rue Louis Bleriot  
Z.A.C. de Toul Garros  
56400 Aurray, France  
Tel: +33 297562080



Columbus  
Brordrupvej 44  
DK-4621 Gadstrup  
Denmark  
Tel: +45 46191166



Japan  
Cosmos Marine  
2-42 Nishinomiya  
Hyogo Pref  
Japan 6620934

## UK

## ■ Spares Marine

Pomeroy  
Marcombe rd  
Torquay, TQ2 6LL  
Tel: +44 (0) 1803 607 299  
Email: steve@sparesmarine.co.uk

## ■ Force 4 Chandlery

Deacons Boatyard  
Bridge Rd, Bursledon  
Southampton SO31 8AW  
Tel: +44 (0) 2380 402182

## ■ Fox's Marina

The Strand, Wherstead  
Ipswich, Suffolk  
Tel: +44 (0) 1473 689111  
Fax: +44 (0) 1473 601737

## ■ Maldon Chandlers

Shipways  
North Street  
Maldon  
Essex CM9 5HQ  
Tel: +44 (0) 1621 854280

## EUROPE

## AUSTRIA

■ Welebny Yacht Equipment  
Hausleiten 7 Tillysburg  
A-4490 ST FLORIAN, AUSTRIA  
Tel: +43 7224 4111  
Fax: +43 7224 4113  
Website: www.welebny.com  
Email: office@welebny.com

## BELGIUM

■ West-Diep Yachting Center  
Louisweg 2  
B-8620 Nieuwport, BELGIUM  
Tel: +32 5823 4061  
Fax: +32 5823 9248  
Website: www.westdiep.com  
Email: info@westdiep.com

## DENMARK

■ E V Schou & Co  
Adilsvej 5  
2000 Copenhagen DENMARK  
Tel: +45 381 95555  
Fax: +45 381 91010  
Website: www.evesco.dk  
Email: evesco@evesco.dk

## FINLAND

■ Meredin-Ulkoiuaitta Oy  
Puolalankatu 6  
20100 Turku, FINLAND  
Tel: +358 2275 275  
Fax: +358 2275 2760  
Website: www.meredin.fi  
Email: meredin@meredin.fi

## FRANCE

■ Discount Marine  
BP 60114  
12 Rue Liot  
92100 Boulogne Billancourt  
France  
Tel: 0033 146 20 4242

## GERMANY

## ■ Toplicht

Schiffsausrüstung GMBH  
Nofkestrasse 97  
22607 Hamburg  
Tel: 0049 408890100  
Email: toplicht@toplicht.de

## GIBRALTAR

## ■ H Sheppard &amp; Co Ltd

Yacht Marina  
Waterport GIBRALTAR  
Tel: +350 77183/75148  
Fax: +350 42535  
Website: www.sheppard.gi  
Email: info@sheppard.gi

## GREECE

## ■ Nautilus Ltd

Metamorfoseeos 2  
Alimos 174-55  
Athens GREECE  
Tel: +30 1 9854238  
Fax: +301 9849444  
Website: www.nautilus.gr  
Email: info@nautilus.gr

## HOLLAND

## ■ Belship BV

Krommewetering 61A  
3543 AM Utrecht, HOLLAND  
Tel: +31 (0)30 240 8040  
Fax: +31 (0)30 240 8041  
Website: http://www.belship.nl  
Email: team@belship.nl

## NORWAY

## ■ Progress Ingenioerfirma as

Frysjaeveien 33E  
N-0884 Oslo NORWAY  
Tel: +47 22027900  
Fax: +47 22027901  
Website: www.progressing.no  
Email: post@progressing.no

## SPAIN

## ■ Acastimar

Poligono Belianes  
C/Fusterias, 22  
43850 Cambrils, SPAIN  
Tel: +34 977 362118  
Fax: +34 977 362687  
Website: www.acastimar.com  
Email: acastimar@acastimar.com

## SWITZERLAND

## ■ Bucher &amp; Walt SA

(Blakes & Lavac Products Only)  
Route de Soleure 9  
2072 St Blaise SWITZERLAND  
Tel: +41 32 755 9500  
Fax: +41 32 7559530  
Website: http://www.bucherwalt.ch  
Email: info@bucher-walt.ch

## REST OF THE WORLD

## AUSTRALIA

■ Southern Seas Marine  
Gold Coast City Marine  
A6 Waterways Drive  
Coomera 4209  
Queensland, Australia

## CANADA

## ■ North West Marine Distributors

26940 26th Avenue  
Aldergrove, British Columbia  
V4W2Y6  
CANADA  
Tel: +1 (604) 607-7901  
Fax: +1 (604) 607-7902  
Website: www.northwestmarine.ca  
Email: marineaccess@telus.net

## NETHERLANDS ANTILLES

## ■ Budget Marine NV

25B Waterfront Road  
Cole Bay  
St Maarten  
NETHERLANDS ANTILLES  
Tel: +599 5443134  
Fax: +599 5444409  
Website: http://www.budgetmarine.com  
Email: sales@budmar.an

## NEW ZEALAND

## ■ A Foster &amp; Co Ltd

30-36 Fanshawe Street  
PO Box 1951  
Auckland 1  
NEW ZEALAND  
Tel: +64 (0)93033 744  
Fax: +64 (0)93077 987  
Email: admin@fosterandco.co.nz

## SINGAPORE

## ■ Tawa Private Ltd

12 Joo Seng Road  
#14-57  
SINGAPORE 360012  
Tel: +65 2800678  
Fax: +65 2854152  
Email: tawas@signal.com.sg

## SOUTH AFRICA

## ■ Central Boating (Pty) Ltd

85 Bree Street  
Cape Town 80001  
SOUTH AFRICA  
Tel: +27 (0)21 4248026  
Fax: +27 (0)21 4242564  
Website: www.centralboating.co.za  
Email: david@centralboating.co.za

## USA

## ■ St Brendans Isle

Green Cove Springs  
Florida  
USA 32043  
Tel: +1 860 701 3400  
Fax: +1 860 701 3424  
Email: sbi@sbimailsservice.com





**SeaSure Ltd**

Clock Tower Works  
Shore Road  
Warsash  
Hampshire SO31 9GQ  
England

## STAFF CONTACTS

Telephone: +44 (0)1489 885 401  
Facsimile: +44 (0)1489 885 402  
Email: [sales@sea-sure.co.uk](mailto:sales@sea-sure.co.uk)  
[www.sea-sure.co.uk](http://www.sea-sure.co.uk)

## SEASURE CONTACTS

**Graham Brown - Managing Director**

Email: [grahambrown@sea-sure.co.uk](mailto:grahambrown@sea-sure.co.uk)

**Jackie Crosby - Operations Director**

Email: [jackiecrosby@sea-sure.co.uk](mailto:jackiecrosby@sea-sure.co.uk)

**Daniel Henderson - Sales Manager**

Email: [danielhenderson@sea-sure.co.uk](mailto:danielhenderson@sea-sure.co.uk)



UK MANUFACTURER



PERFORMANCE EQUIPMENT FOR HARSH ENVIRONMENTS

[www.sea-sure.co.uk](http://www.sea-sure.co.uk)